



Sent via e-mail

July 25, 2017

Wayne Dillard, P.E.
U.S. Environmental Protection Agency – Region 7
Water, Wetlands and Pesticides Division
11201 Renner Boulevard
Lenexa, KS 66219
Dillard.Wayne@epa.gov

RE: SSO (Sanitary Sewer Overflow) Order of Compliance – Docket No. CWA-07-2015-0022
Compliance Actions – City of Leavenworth
Timeframe: January 1, 2017 to June 30, 2017

Mr. Dillard:

Pursuant to Paragraphs 37 and 38 of the Order of Compliance on Consent, Docket No. CWA-07-2015-0022, the City of Leavenworth, Kansas is providing the following:

Paragraph 37. Attached is a listing of SSO “Transparency Report” notifications on the City of Leavenworth web page at www.lvks.org. These are related to SSO events that reached the waters of the United States. Additional notifications of these events were made by the city Public Information Officer via Social Media and elsewhere on the City’s Web page www.lvks.org.

There were nine SSO events that reached the Waters of the United States between January 1, 2017 and June 30, 2017. These events were reported to the Kansas Department of Health and Environment.

1. Feb. 18, 2017, Water Pollution Control (WPC) was notified of a private line sanitary sewer overflow at 2:15 p.m. at 804 S. Fourth Street. A private sewer line had overflowed onto the ground and into a storm drain. An estimated 300 gallons of sewer water was released into the storm drain.
2. Feb. 22, 2017, Water Pollution Control found a leak in a City sewer line near 1512 Osage Street to 15th Street. The leak was discovered during the City’s Quarterly Creek Crossing inspections. Quantity is not known.
3. April 3, 2017, a resident contacted Water Pollution Control that a manhole was overflowing at 8:30 a.m. in the 1400 block of Ottawa Street next to the creek. Excessive rainfall was the likely cause. An estimated 4,500 gallons flowed into the nearby creek.

4. April 21, WPC found a sewer leak near 1313 Fourth Avenue after a report from a concerned citizen called the WPC 24-hour line. Manhole 0536 had overflowed into a creek 165 feet west of 1313 Fourth Avenue. WPC inserted a rod into the sewer line and removed the cause of the blockage.
5. April 22, 2017. Resident at 1220 Dakota called regarding USP Leavenworth (Bureau of Prisons) lift station overflowing into the creek. (City of Leavenworth has no jurisdiction over Bureau of Prisons even though it is within the City of Leavenworth). USP Officials cleaned the area and claimed 50 gallons were released.
6. May 16, 2017. Citizen called regarding sewer in creek at 804 S. 3rd Street. City staff investigated with home inspections and dye testing. No cause was determined; illegal dumping of motorhome is suspected. Quantity of discharge is unknown.
7. May 30, 2017. Citizen called regarding odor behind home at 524 Elizabeth Street. Manhole in remote area was overflowing. City forces removed blockage. Quantity of discharge estimated at 600 gallons.
8. June 9, 2017. Reports of USP Leavenworth (Bureau of Prisons) lift station overflowing into creek were received by City. (City of Leavenworth has no jurisdiction over Bureau of Prisons even though it is within the City of Leavenworth). USP Officials cleaned the area and claimed 50 gallons were released.
9. June 19, 2017. Plumber working at 100 Highway Terrace contacted city and stated that the private lift station at his location had overflowed into the detention basin, and then flowed out of the detention basin. The outlet of the detention basin discharges into the City of Lansing. City of Leavenworth representatives contacted the City of Lansing representatives and informed them of the situation.

A copy of the transparency reports related to these nine events is attached.

Paragraph 38. Describe actions taken by the City between January 1, 2017 and June 30, 2017 to comply with this order, and attach copies of all SSO reports submitted to KDHE.

(a) The number of unauthorized discharges which occur within the City's POTW (Publicly-Owned Treatment Works) during the reporting period:

- 46 SSO events occurred during this period and were reported to KDHE. A summary report showing each event and resolution of the event is included with this letter.
 - 36 Private Line events. 4 reached the waters of the United States.
 - 9 City Line events. 4 reached waters of the United States.
 - 1 location from unknown source reached waters of the United States.

SSO Events within the City Limits, but outside the jurisdiction of the city include the following, and these are included in the above total SSO count of 46:

- 1 Fort Leavenworth SSO event (4/7/17) was reported by American Water to KDHE. A copy of this report is included. It is unknown if this event reached the waters of the United States. This event IS included in the totals above for Private Lines even though it did not impact property under the jurisdiction of the City of Leavenworth. (The City of Leavenworth has no jurisdiction on Fort Leavenworth even though it is inside the city limits. The reports do reflect an improved level of communication).
- 2 USP Leavenworth (Bureau of Prisons) SSO events (4/22/17, 6/9/17) occurred during the reporting period. Both reached waters of the United States after entering property under the jurisdiction of the City of Leavenworth when the USP Lift Station failed. KDHE reports were submitted to KDHE by USP and are included here. These SSOs ARE included in the totals above for Private Lines. (The City of Leavenworth has no jurisdiction on USP Leavenworth even though it is inside the city limits. The reports do reflect an improved level of communication.)

(b.) The specific measures taken by the City to correct and prevent recurrence of each unauthorized discharge which occurred within the City's POTW during the reporting period:

The City and residents have taken the actions as noted in the summary report related to Paragraph 38, section (a) above. In addition to those efforts, the following work occurred in the reporting period:

1. City continues to operate a CCTV crew. 2.37 miles of sanitary sewer were inspected during the reporting period. An additional 820 feet of storm sewer lines were inspected.
2. City continues to operate a cleaning and root elimination crew. 25.0 miles were cleaned during the reporting period. An additional 120 feet of storm sewer were cleaned.
3. Root Control contract was awarded on March 31, 2017 and completed in this period. The contract was for \$21,103.77 and 15,817 feet of lines were treated.
4. City continues to operate a grease trap inspection program. Letters are sent to selected relevant businesses monthly and all known owners are contacted at least one time each year. Twenty-five businesses were contacted in the reporting period. The letters inform businesses of the program and the city requests copies of maintenance records. Physical inspections have been completed at 15 grease trap installations during the reporting period. At least one new installation has occurred as a result of this effort in the first half of 2017. Currently five businesses have not yet complied with city requests, but have received letters regarding the need for inspection.
5. City opened bids on June 21, 2017 for annual Inflow/Infiltration work (engineers estimate \$589,000). Due to problems with the low bid submitted, all bids were rejected by the City Commission. The project will be rebid later in 2017.

6. City forces conducted a smoke test program on approximately 1400 feet of trunk sewers along Three-Mile Creek during the reporting period seeking large inflow sources. One substantial illegal connection of the stormwater system to the sanitary system was identified. This has since been rectified at property owner's expense.
7. City efforts related to retention of employees has resulted in the following during the reporting period:
 - a. Two employees separated from WPC (one was an internal transfer to Streets Division). Three new employees were hired. There is currently one operator vacancy that is being advertised.
 - b. Training and education opportunities are available for all operators. All KDHE certified operators are current in their requirements to retain their certification. Two staff attended an 8-hour hazmat class, and selected operators have been trained on the new pole camera. Two operators attended a workshop on lagoon operation and maintenance.
8. Two cycles of creek-crossing inspections have occurred in the reporting period. Two locations requiring maintenance were identified. An outside contractor was selected to address these issues with two contracts to perform debris removal work.
9. Coordination with local plumbers on expected practices related to SSOs has been improved through discussion and interaction with city staff. Material related to proper procedures for addressing SSO issues was mailed to all licensed plumbers. A meeting to discuss this material was held on April 28, 2017 with representatives of five local plumbing firms in attendance.
10. The "Trouble Line" list continues to be investigated by city staff. These thirty-one lines are subjected to additional routine cleaning or inspection on approximately a monthly basis due to previous situations. City staff selected nine lines to evaluate for possible removal from the list or to develop recommended repairs during 2017. Maintenance intervals have been increased without any known issues. These nine lines have therefore been removed from this list during the reporting period due to the results of the evaluation. There are now twenty-two lines on the list. Staff will continue to evaluate the remaining lines.
11. City contracted with Service Line Warranties of America to provide an affordable repair option for all residential sewer lines (private lines). This optional program began in January 2017. Records indicate that 127 customers were registered for the sewer line warranty program as of June 30, 2017.
12. City Community Development Block Grant (CDBG) funds may be used to fund homeowner private sewer line repair or water line repair up to a maximum cap of \$5,000 depending on income qualifications. There were no sewer line repairs during the reporting period.

13. City recognizes the following areas for possible improvement and is working toward that end:

- a. Detention Basin owners/operators are being notified that they need to have a plan to address how they will operate the facility in the event of contamination of the water from a SSO or other spill.
- b. Coordination with Federal Agencies (particularly Bureau of Prisons and Fort Leavenworth) on how they are addressing SSO issues is occasionally difficult. City Staff will continue to maintain relationships with these institutions to improve response time to SSO events.
- c. City staff continues to review and improve processes to ensure timely notification of the public through the Transparency Report.

(c.) A copy of each unauthorized discharge report submitted to KDHE:

Copies of 46 SSO reports are attached to this letter. This includes one event on Fort Leavenworth and two events originating on USP.

If you have any questions or need additional documentation, please don't hesitate to contact me at 913-684-0375 or by email at mmcdonald@firstcity.org.

Sincerely,



Michael G. McDonald, P.E.,
Director of Public Works

Cc Paul Kramer, City Manager
Jaime Gaggero, Director, Bureau of Water, KDHE (sent via U.S. mail)
Brittany A. Barrientos, Attorney

Attachments

- Screenshots of on-line Transparency Report with details of nine events
- Spreadsheet with summary of corrective action on SSO events
- KDHE SSO reports for 46 events
- Material related to Service Line Warranties of America
- Material related to meeting with local plumbers related to SSO procedures

City of Leavenworth

SSO Summary January 1 - June 30, 2017

No.	Date	Address	Nature of Problem	SSO	Problem	Trans. Report	Solution
1	1/3/2017	1623 4th Ave.	Sewer on street	y	plt		Placed down containment socks. Informed owner to call a plumber. Permit issued; inspected.
2	1/1/2017	217 N Broadway	Water running down alley	y	plt		Cleaned up area. Left notice on door. Repair was completed 1/4/17 @ 4:00 p.m. Permit issued, inspected
3	1/15/2017	701 13th Terrace	Sewage in Garage	y	cit		Rodded line. Water was contained in basement.
4	1/19/2017	1234 Kiowa	Leaking out of cleanout	y	cit		Rodded to open line. Spread lime on ground. Asked plumber to shut off sump pump.
5	1/20/2017	312 Pine St.	Leaking out of cleanout	y	plt		Placed containment socks around clean out. Informed plumbing inspector.
6	2/3/2017	510 Isabell St.	Sewage leaking out of manhole (MH)	y	cit		MH full, rodde, hit blockage and water receded.
7	2/16/2017	312 Pine St.	Leaking out of cleanout	y	plt		Contacted inspections. Placed containment socks down.
8	2/15/2017	622 W. 7th 733 Chestnut	Leaking out of cleanout	y	plt		Placed containment socks down. Repairs were made 2/7/17 @ 5:00 pm.
9	2/18/2017	804 S. 4th	Leaking out of cleanout	y	plt	Yes	Informed homeowner to call plumber. Placed down containment sock.
10	2/21/2017	625 Dakota	Leaking out of cleanout	y	plt		Placed down containment socks. Turned it over to inspections. Water disconnected, permit issued, inspected.
11	2/22/2017	1512 Osage	Creek crossing was leaking	y	cit	Yes	Line was removed and new ductile iron installed. Line was repaired 2/22 @ 1:30 p.m.
12	3/2/2017	415 Vine St.	Leaking out of cleanout	y	plt		Placed down containment socks. Inspector informed homeowner to call plumber.
13	3/2/2017	2613 S. 4th St.	Cleaning crew blew back through to the house	y	cit		Placed line on maintenance list.
14	3/8/2017	787 Pennsylvania Ave.	Basement backed up full of sewage	y	plt		Informed homeowner to call plumber.
15	3/12/2017	1206 Klomp	Sewer backed up in basement	y	plt		Informed homeowner to call plumber.
16	3/15/2017	733 Kickapoo	Backing up in basement out into backyard and alley.	y	plt		After rodding, toilet was flushing normal.
17	3/16/2017	1028/1032 9th Ave.	Backing up in basement out into driveway	y	plt		Informed homeowner to call plumber.
18	3/28/2017	504/506 Delaware	Sewer smell/ found sewage in basement	y	plt		Plumber repaired.
19	3/28/2017	604 S. 6th	Sewage in basement	y	plt		Informed homeowner to call plumber.
20	3/29/2017	407 Sheridan	Sewage in basemnt	y	cit		Rodded, hit blockage and water went down.
21	3/31/2017	528 Pawnee	Leaking out of cleanout	y	plt		Plumber repaired.
22	4/28/2017	2900 Meadow	Backup in basement	y	plt		Informed homeowner to call plumber.
23	4/22/2017	1220 Dakota St.	Sewage out of lift station (prison)	y	plt	Yes	Ordering new pumps and updating breaker boxes.
24	4/22/2017	810 Pottawatomie	Backup in basement	y	plt		Informed homeowner to call plumber.
25	4/21/2017	1313 4th Ave.	Sewage out of manhole (creek)	y	cit	Yes	Rodded line, hit root ball and water receded. Placed contaminated creek signs.
26	4/7/2017	Fort Leavenworth	Sewage out of manhole	y	plt		Vacuumed debris and spread lime.
27	4/11/2017	1623 4th Ave.	Sewer running down road	y	plt		Placed containment socks down. Plumber repaired.
28	4/13/2017	1326 Olive St.	Leaking out of cleanout	y	plt		Plumber repaired.
29	4/7/2017	1129 Metropolitan	Backup in basement	y	plt		Plumber repaired.
30	4/3/2017	1030 Randolph St.	Backup in basement	y	plt		Placed containment socks down. Informed homeowner to call plumber.
31	4/3/2017	1414/1415 Ottawa	Sewage out of manhole (creek)	y	plt	Yes	Placed containment socks down and put out contaminated creek signs.
32	5/17/2017	1314 Cherokee	Backup in basement	y	plt		Homeowner called plumber.
33	5/16/2017	803 S. 3rd St.	Sewer smell in creek	y	other	Yes	Rodded. CCTV'd. Dyed line, didn't observe dye in creek.
34	5/30/2017	524 Elizabeth	Sewage backing up into creek	y	cit	Yes	Rodded, hit blockage and water went down. Cleaned up around MH. Put out contaminated creek signs.
35	5/30/2017	316 N. 4th & Miami	Leaking through drains manhole backed up	y	cit		Used small flush truck to open line.
36	5/30/2017	788 Charles	Sewage in basement	y	plt		Plumber repaired.
37	5/30/2017	400 Grand Ave.	Sewage leaking out of lateral	y	plt		Informed homeowner to call plumber.
38	5/30/2017	1504 5th Ave.	Backup in drains	y	plt		Plumber repaired.
39	6/6/2017	1800 S. 2nd	Power outage	y	plant		Power was restored, all was normal.
40	6/6/2017	423 Chestnut	Broken lateral hit by construction	y	plt		Plumber repaired.
41	6/9/2017	Federal Prison	Lift station overflow	y	plt	Yes	Ordering new pumps and updating breaker boxes.
42	6/6/2017	603 Ottawa	Leaking from lateral	y	plt		Homeowner had line repaired.
43	6/7/2017	1007 Central Ave.	Backup in basement	y	plt		Informed homeowner to call plumber.
44	6/5/2017	1209 Spruce	Leaking out of cleanout	y	plt		Placed containment socks down. Plumber repaired.
45	6/9/2017	707 S. 6th St.	Sewage in basement	y	plt		Informed homeowner to call plumber.
46	6/19/2017	100 Highway Terrace	Grinder pump station overflow	y	plt	Yes	Westar energy replaced two fuses on utility pole.
<p>Note: plt = Private line trouble cit = City line trouble plant = WWTP (Wastewater Treatment Plant)</p>							



Welcome to

Leavenworth

Kansas

SEARCH THE SITE



Home

Departments

Residents

Businesses

Visitors

Media Room

Services

Contact Us

Chuck Staples,
Supervisor, Water Pollution
Control

**Wastewater Treatment
Plant** [\(more\)](#)
1800 S 2nd St
Leavenworth, KS 66048
[Get Directions](#)

Assistant:
(913) 682-1090

Department Staff

Related Topics

[Department Home](#)

Topics

[Grow Leavenworth
County Development
Corporation \(an E-
Community\)](#)

[Application for
Subdivision
Development](#)

[Economic
Development Grants](#)

[Weather and Rainfall
Information for
Leavenworth](#)

[Sister City Program](#)

[Brush Site](#)

[Sanitary Sewer
Overflow
Transparency Report](#)

You are here: [Home](#) > [Departments](#) > [Sanitary Sewer Overflow Transparency Report](#)

About This
Topic

Documents
& Reports

More
Information

News &
Notices

Sanitary Sewer Overflow Transparency Report

City crews work to keep the main sewer lines clean and maintained. There is occasionally a break in a sewer line that can lead to discharge of untreated sewage, possibly reaching the stormwater drainage system. We urge Leavenworth residents to contact us immediately if they see signs of a sewer discharge at 913-682-1090. Crews respond to system user requests for service 24 hours a day 7 days a week.

The City of Leavenworth can only verify the City main lines. A lateral line is the line that runs from a residence or business to the City sewer mains. We cannot verify blockages in lateral lines. This must be done by a licensed plumbing company.

Information on Sanitary Sewer Overflows is made available to the general public as part of the City's transparency efforts.

2016

- Sanitary Sewer Overflow reported Feb. 22, 2016 between Seventh and Broadway and Ottawa and Kickapoo
- Sanitary Sewer Overflow reported March 23, 2016 at Iowa and Oregon streets
- Sanitary Sewer Overflow reported April 10, 2016 south of Metropolitan Avenue
- Sanitary Sewer Overflow reported April 12, 2016 at 11th and Cherokee
- Sanitary Sewer Overflow reported April 26, 2016 at 555 Ohio
- Sanitary Sewer Overflow reported May 11, 2016 at Second and Elm
- Sanitary Sewer Overflows as a result of May 26, 2016 rainstorm
- Sanitary Sewer Overflow reported June 5 at Buffalo Bill Cody Park
- Sanitary Sewer Overflow reported July 2, 2016, at manholes throughout the City.
- Sanitary Sewer Overflows on July 5, 2016
- Sanitary Sewer Overflows on Sept. 14, 2016

2017

- Sanitary Sewer Overflow reported Feb. 18, 2017 near Fourth and Spruce streets
- Sanitary Sewer Overflow reported Feb. 22, 2017
- Sanitary Sewer Overflow reported April 3, 2017
- Sanitary Sewer Overflow reported April 21, 2017
- Sanitary Sewer Overflow reported April 22, 2017
- Sanitary Sewer leak reported May 16, 2017
- Sanitary Sewer Overflow reported May 30, 2017
- Sanitary Sewer Overflow reported June 9, 2017
- Sanitary Sewer Overflow for June 19, 2017



Contact Us

100 N. 5th St.
Leavenworth, KS 66048
[Get Directions](#)

- Phone:
(913) 682-9201
- Email Us
- Staff Directory

Sanitary Sewer Overflow reported Feb. 18 near Fourth and Spruce streets

Feb. 21, 2017

On Feb. 18, 2017, Water Pollution Control was notified of a private line sanitary sewer overflow at 2:15 p.m. at 804 S. Fourth Street. A private sewer line had overflowed onto the ground and into a storm drain. An estimated 300 gallons of sewer water was released into the storm drain.

ACTIONS TAKEN: City staff responded and was able to prevent more water from reaching the storm drain. Staff put a sign up to warn any passersby near the open storm drain. The rest of the surrounding storm drains were underground. City staff reported the incident to the Kansas Department of Health and Environment.

RISK TO PUBLIC: An estimated volume of 300 gallons of sewer water was carried downstream. Residents should avoid the open storm drain for the next five days. The area is between Spruce and Olive streets just east of Fourth Street/Kansas Highway 7.

FURTHER ACTIONS TAKEN – The City confirmed that the private owner of the sewer line would have plumbing staff fix the problem.

WHAT RESIDENTS CAN DO TO HELP: Residents experiencing a sewer problem can call the 24-hour line, 913-682-1090. An on-call crew will come out anytime. Residents are responsible for sewer lines on their property.

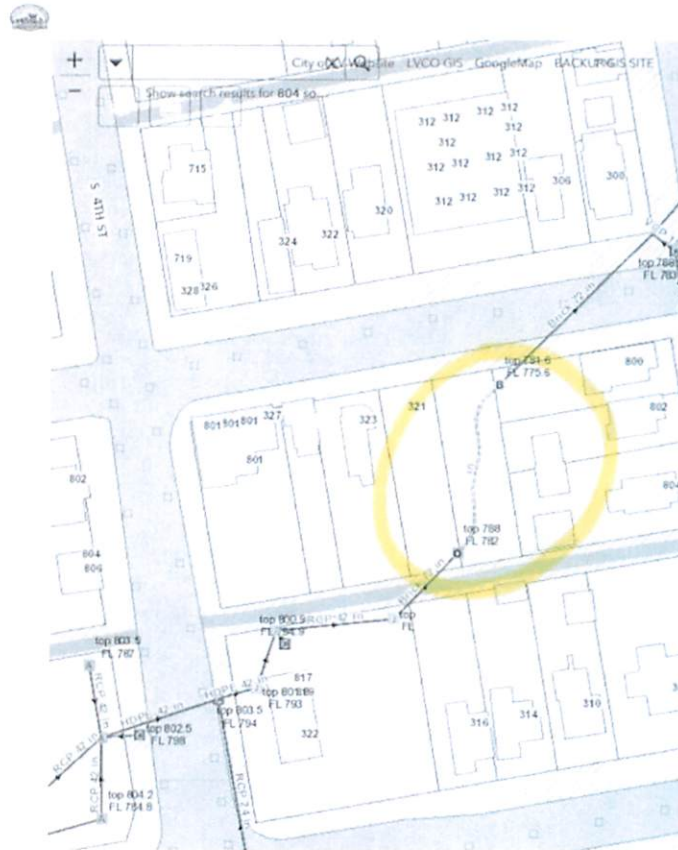



Contact Us

100 N. 5th St
Leavenworth, KS 66048
[Get Directions](#)

Phone:
(913) 682-9201

Email Us

Staff Directory

Sanitary Sewer Overflow reported Feb. 22

On Feb. 22, 2017, Water Pollution Control found a leak in a City sewer line near 1512 Osage Street to 15th Street. The leak was discovered during the City's Quarterly Creek Crossing inspections. During this process, the inspectors put a nontoxic green dye that is designed to dissipate naturally. Although there was no leak shown previously, a leak was discovered in older portions of the sewer line.

Contractors were in the process of replacing the sewer line with more durable material when the leak was discovered. It is unknown how long the leak occurred.

ACTIONS TAKEN: The City plugged the damaged sewer line and bypassed it so that it could be fixed. The City reported the incident to the Kansas Department of Health and Environment.

RISK TO PUBLIC: Residents should avoid the area, which is marked with signs, until water testing shows the area is safe from E. coli.

FURTHER ACTIONS TAKEN: The City is replacing the sewer line in this area with ductile iron so that it will be more durable during periods of high rainfall. Staff will continue testing water samples from the area and remove signs when tests show acceptable levels.

WHAT RESIDENTS CAN DO TO HELP: If you notice a sewer smell or leak in the area, contact the 24-hour line, 913-682-1090.

SSO Event 1512 Osage St



- February 23, 2017
- Manholes**
- Manhole
 - Force Mains
 - Pavement
 - Flushtank
 - Gravity Mains
 - Parcels
 - Lampole
 - Lift Stations
 - Parcels (City Owned)



© 2014 City of Leavenworth
2014 City of Leavenworth



KANSAS

Home

Departments

Residents

Businesses

Media Room

Services

Contact Us

100 N. 4th St.
Leavenworth, KS 66048
Get Directions

Phone:
(913) 682-9201

Email Us

Start Directory

Sanitary Sewer Overflow reported April 3

April 3, 2017

On April 3, 2017, a resident contacted Water Pollution Control that a manhole was overflowing at 8:30 a.m. in the 1400 block of Ottawa Street next to the creek. Excessive rainfall was the likely cause. An estimated 4,500 flowed into the nearby creek.

ACTIONS TAKEN: Water Pollution Control staff responded to the scene and were able to open the line causing the manhole to overflow. The manhole stopped overflowing around 9:30 a.m. "Contaminated Creek" signs have been placed around the area.

Risk to public: Residents should avoid the maired area.

Further actions taken: Staff are testing for E-Coli. Signs will be removed when water samples are back within acceptable limits set by the Kansas Department of Health and Environment.

What residents can do to help: The City would like to thank residents who call in and report overflowing manhole covers. The City has a 24-hour line, 913-682-1090, for residents to report incidents.



SSO Map - 1400 Block of Ottawa
April 3, 2017



Welcome to

Leavenworth

Kansas

Site Search



[Home](#)

[Departments](#)

[Residents](#)

[Businesses](#)

[Visitors](#)

[Media Room](#)

[Services](#)

Contact Us

100 N. 5th St.
Leavenworth, KS 66048
[Get Directions](#)



Phone:
(913) 682-9201



[Email Us](#)



[Staff Directory](#)

Sanitary Sewer Overflow reported April 21

On April 21, WPC found a sewer leak near 1313 Fourth Avenue. A concerned citizen called the WPC 24-hour line. He told staff that his address smelled like sewer.

ACTION TAKEN: Staff inspected and found that Manhole 0536 had overflowed into a creek 165 feet west of 1313 Fourth Avenue. WPC inserted a rod into the sewer line and removed the cause of the blockage.

RISK TO PUBLIC: The City of Leavenworth Public Works Department asks citizens to stay away from the creek. Locations are west of Fourth Avenue to Second Avenue, between Middle and Prosepect streets from Second Avenue to Fifth Street and between Elm and Vine streets.

FURTHER ACTION TAKEN: WPC placed contaminated creek signs and will take water quality samples. These signs will remain in place until the water quality is back to normal levels.

WHAT RESIDENTS CAN DO TO HELP: Please keep children and pets away from the creek. Citizens should contact WPC, 913-682-1090, anytime they smell sewer or see sanitary sewer water on the ground.



Welcome to

Leavenworth

Kansas

Site Search



[Home](#)

[Departments](#)

[Residents](#)

[Businesses](#)

[Visitors](#)

[Media Room](#)

[Services](#)

Contact Us

100 N. 5th St.
Leavenworth, KS 66048
[Get Directions](#)



Phone:
(913) 682-9201



[Email Us](#)



[Staff Directory](#)

PRELIMINARY Report: possible contamination near 819 S 4th St.

After responding to a call on May 16, Leavenworth Water Pollution Control staff found a possible contamination in the creek north of 819 S 4th St. between Third and Fourth streets on City-owned property. Staff have pumped the creek out to the nearest manhole and posted signs in the alley.

- [Home](#)
- [Departments](#)
- [Residents](#)
- [Businesses](#)
- [Visitors](#)
- [Media Room](#)
- [Services](#)

First City of Kansas • 1854

Welcome to **Leavenworth** Kansas

Site Search SEARCH THE SITE

Contact Us

- 
 Phone: (813) 682-8201
- 
 Email Us
- 
 Staff Directory

LOCATION: Federal Prison Lift Station at 12th Metropolitan
ACTION TAKEN: A concerned citizen that lives on Dakota Street called stating the creek smelled like sewer. WPC responded and found the lift station for the Federal Prison had overflowed but was no longer overflowing when our crew arrived.
RISK TO PUBLIC: The City of Leavenworth and Public Works would ask that citizens keep children and pets away from the creek between 12th and 13 Street from Metropolitan to Ottawa Street.
FURTHER ACTION TAKEN: The Environmental Officer for the Federal Prison will be having the creek flushed and also will be taking water quality samples.
WHAT RESIDENTS CAN DO TO HELP: Please contact WPC when you smell sewer or see sanitary sewer on the ground.

Sanitary Sewer Overflow for April 22, 2017



Welcome to

Leavenworth

Kansas

Site Search



[Home](#)

[Departments](#)

[Residents](#)

[Businesses](#)

[Visitors](#)

[Media Room](#)

[Services](#)

Contact Us

100 N. 5th St.
Leavenworth, KS 66048
[Get Directions](#)



Phone:
(913) 682-9201



[Email Us](#)



[Staff Directory](#)

Sanitary Sewer Overflow reported May 30

Water Pollution Control received a call May 30, 2017 at 8:30 am from a concerned citizen stating that a manhole behind their house was overflowing into the creek.

ACTION TAKEN: Upon arrival the citizen showed WPC the manhole that was 75 yards into the woods behind his house. WPC located the downstream manhole and within 30 minutes had the blockage removed and the manhole was no longer overflowing. WPC then cleaned up around the manhole and placed contaminated creek sign along the creek that run east of 2nd Ave to 4th street between Maple street and Elizabeth street.

FURTHER ACTION TAKEN: WPC has taken water samples and will leave the contaminated creek signs out until the water samples are within KDHE requirements.

RISK TO PUBLIC: Public works would ask that residents keep their children and pets away from this creek until the sign are removed. **UPDATE:** The area is no longer restricted after improvement to the water quality. Signs have been removed.

WHAT RESIDENTS CAN DO TO HELP: Public Works would also remind residents to contact WPC any time day or night and weekends if they notice water running down the street or alley and if they smell sewer gas. Please call 913-682-1090



Welcome to

Leavenworth

Kansas

Site Search



Home

Departments

Residents

Businesses

Visitors

Media Room

Services

Contact Us

100 N. 5th St.
Leavenworth, KS 66048
[Get Directions](#)



Phone:
(913) 682-9201



[Email Us](#)



[Staff Directory](#)

Sanitary Sewer Overflow Reported June 9

At 11:39 on June 9, a concerned citizen that lives on Pawnee Street contacted Water Pollution Control, stating that the creek smelled like sewer.

WPC responded and found the Federal Prison lift station had overflowed. Overflow had run into the storm drain and into the creek south of Metropolitan Street. Water Pollution Control contacted the Federal Prison and let them know the lift station had overflowed. The Federal Prison has responded by contacting a company to help with the cleanup.

The City asks residents to keep their children and pets away from the restricted area. The restricted area is between 12th and 13th Street from Metropolitan to Ottawa Street. The Environmental Officer from the Federal Prison will be responsible for cleaning the creek and taking water quality samples from the creek.

City of Leavenworth, KS GIS Web Map



April 24, 2017

1:18,056

Streets	2014	Red_Band_1	Green_Band_2	Blue_Band_3	Leavenworth City Limits
Ortho		Red_Band_1	Green_Band_2	Blue_Band_3	

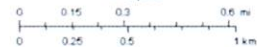

City of Leavenworth, KS



Welcome to

Leavenworth

Kansas

Site Search



[Home](#)

[Departments](#)

[Residents](#)

[Businesses](#)

[Visitors](#)

[Media Room](#)

[Services](#)

Contact Us

100 N. 5th St.
Leavenworth, KS 66048
[Get Directions](#)



Phone:
(913) 682-9201



[Email Us](#)



[Staff Directory](#)

Sanitary Sewer Overflow for June 19

Plumber working at 100 Highway Terrace contacted city and stated that the private lift station at his location had overflowed into the detention basin, and then flowed out of the detention basin. The outlet of the detention basin discharges into City of Lansing. City of Leavenworth representatives contacted City of Lansing representatives and informed them of the situation.

SANITARY SEWER OVRFLOWS

JANUARY 2017

**KANSAS DEPARTMENT OF HEALTH AND ENVIRONMENT
WASTEWATER INCIDENT REPORT FORM**

Definitions are available at <http://www.kdheks.gov/water/tech.html>

Collection System Bypass In-Plant Diversion Upset In-Plant Flow Through Spill

1. FACILITY NAME: Leavenworth, City of Kansas Permit # M-MO12-IO01

2. Within 24 hours of discovery, notify the KDHE Central Office (email – cseeds@kdheks.gov), (fax 785.296.0086), (telephone 785.296.5517) or your local KDHE district office. Written notification is required within 5 days of discovery. If the incident is not corrected within 5 days, send a written notification to KDHE indicating the status. This form is to be sent to KDHE when the incident ends.

KDHE Person Contacted: Chris Seeds Date: 1/11/17 Time: 1:32 pm

3. Date Incident Discovered: 1/3/2017 Time: 3:25 pm

4. Date Incident Ended: 1/10/2017 Time: 4:00 pm

5. Total estimated gallons bypassed, spilled, or routed through failed equipment for all locations on this form: 2 gallons

6. If rainfall induced event, approximate inches of rainfall n/a

If multiple locations listed below due to rain event, check here

7. Incident Location: (check all that apply)

- | | |
|--|--|
| <input type="checkbox"/> Plant | <input type="checkbox"/> City Collection Line (Line Break / Joint) |
| <input type="checkbox"/> Lift/Pump Station | <input checked="" type="checkbox"/> Private Sewer Line |
| <input type="checkbox"/> Peak Flow Basin | <input type="checkbox"/> Basement |
| <input type="checkbox"/> Manhole(s) | <input type="checkbox"/> Other (specify below) |

Identify **All** Incident Locations by Name, Street Address or Manhole Number as appropriate.

Michael Teachout called stating he had water running at the curb at 1623 4th ave. The upstream M/H is 0745 and the downstream M/H is 0746.

8. Cause of Incident:

- | | |
|---|--|
| <input type="checkbox"/> Intentional Bypass for Repair/Construction | <input type="checkbox"/> Equipment Failure |
| <input type="checkbox"/> Excessive Rainfall, Snow Melt | <input type="checkbox"/> Control System Failure |
| <input type="checkbox"/> Unplanned Construction Related Break | <input type="checkbox"/> Power Related Failure |
| <input type="checkbox"/> City Line Break (Not Construction Related) | <input type="checkbox"/> Operations Related Failure |
| <input type="checkbox"/> City Line Blockage | <input type="checkbox"/> Maintenance Related Failure |
| <input type="checkbox"/> Private Line Break | <input type="checkbox"/> Vandalism |
| <input checked="" type="checkbox"/> Private Line Blockage | <input type="checkbox"/> Other |
| <input type="checkbox"/> Lagoon High Level | |

Additional explanation of reason for incident: (use additional page if necessary)

Upon arrival we checked our line and rodded for 313 feet with no problems. We talked to the owner and informed him he needed to call a plumber. The owner asked where his responsibility ended. He was informed that he is responsible into the main.

9. Corrective Action, if any: (use additional page if necessary)

After talking to the owner we placed containment sock so if any more water ran out it would be contained in the curb line.

Name: Chuck Staples

Date: 1/11/17

Title: Superintendent

Phone: 913-682-1090

When Completed, E-mail to: cseeds@kdheks.gov

**KANSAS DEPARTMENT OF HEALTH AND ENVIRONMENT
WASTEWATER INCIDENT REPORT FORM**

Definitions are available at <http://www.kdheks.gov/water/tech.html>

Collection System Bypass In-Plant Diversion Upset In-Plant Flow Through Spill

1. FACILITY NAME: Leavenworth, City of Kansas Permit # M-MO12-IO01
2. Within 24 hours of discovery, notify the KDHE Central Office (email – cseeds@kdheks.gov), (fax 785.296.0086), (telephone 785.296.5517) or your local KDHE district office. Written notification is required within 5 days of discovery. If the incident is not corrected within 5 days, send a written notification to KDHE indicating the status. This form is to be sent to KDHE when the incident ends.

KDHE Person Contacted: Chris Seeds Date: 1/5/17 Time: 11:16 am

3. Date Incident Discovered: 1/1/2017 Time: 5:07 pm
4. Date Incident Ended: 1/4/2016 Time: 4:00 pm
5. Total estimated gallons bypassed, spilled, or routed through failed equipment for all locations on this form: 125 gallons (Did not reach storm drain)
6. If rainfall induced event, approximate inches of rainfall n/a

If multiple locations listed below due to rain event, check here

7. Incident Location: (check all that apply)

- | | |
|--|--|
| <input type="checkbox"/> Plant | <input type="checkbox"/> City Collection Line (Line Break / Joint) |
| <input type="checkbox"/> Lift/Pump Station | <input checked="" type="checkbox"/> Private Sewer Line |
| <input type="checkbox"/> Peak Flow Basin | <input type="checkbox"/> Basement |
| <input type="checkbox"/> Manhole(s) | <input type="checkbox"/> Other (specify below) |

Identify **All** Incident Locations by Name, Street Address or Manhole Number as appropriate.

We received an e-mail from City Hall stating that water was running down the alley at 217 Broadway Street. The upstream M/H is 0209 and the downstream M/H is 0214.

8. Cause of Incident:

- | | |
|---|--|
| <input type="checkbox"/> Intentional Bypass for Repair/Construction | <input type="checkbox"/> Equipment Failure |
| <input type="checkbox"/> Excessive Rainfall, Snow Melt | <input type="checkbox"/> Control System Failure |
| <input type="checkbox"/> Unplanned Construction Related Break | <input type="checkbox"/> Power Related Failure |
| <input type="checkbox"/> City Line Break (Not Construction Related) | <input type="checkbox"/> Operations Related Failure |
| <input type="checkbox"/> City Line Blockage | <input type="checkbox"/> Maintenance Related Failure |
| <input checked="" type="checkbox"/> Private Line Break | <input type="checkbox"/> Vandalism |
| <input type="checkbox"/> Private Line Blockage | <input type="checkbox"/> Other |
| <input type="checkbox"/> Lagoon High Level | |

Additional explanation of reason for Incident: (use additional page if necessary)

Upon arrival we noticed water running down the alley and the clean out had been broken by a vehicle. We checked our lines and we had good flow. We tried to contact the owner but no one was home.

9. Corrective Action, if any: (use additional page if necessary)

We cleaned up the area and no only around the clean out but in the alley. We placed containment socks and spread lime on the area. We left a notice on the front door. We have monitored the area and was informed this morning the repair was completed at 4:00 pm on the 4th of January.

Name: Chuck Staples Date: 1/05/17
Title: Superintendent Phone: 913-682-1090

When Completed, E-mail to: cseeds@kdheks.gov

**KANSAS DEPARTMENT OF HEALTH AND ENVIRONMENT
WASTEWATER INCIDENT REPORT FORM**

Definitions are available at <http://www.kdheks.gov/water/tech.html>

Collection System Bypass In-Plant Diversion Upset In-Plant Flow Through Spill

1. FACILITY NAME: Leavenworth, City of Kansas Permit # M-MO12-IO01
 2. Within 24 hours of discovery, notify the KDHE Central Office (email – cseeds@kdheks.gov), (fax 785.296.0086), (telephone 785.296.5517) or your local KDHE district office. Written notification is required within 5 days of discovery. If the incident is not corrected within 5 days, send a written notification to KDHE indicating the status. This form is to be sent to KDHE when the incident ends.

KDHE Person Contacted: Chris Seeds Date: 1/7/17 Time: 8:57 am

3. Date Incident Discovered: 1/15/2017 Time: 6:20 pm
 4. Date Incident Ended: 1/15/2017 Time: 7:30 pm
 5. Total estimated gallons bypassed, spilled, or routed through failed equipment for all locations on this form: unknown contained in basement
 6. If rainfall induced event, approximate inches of rainfall n/a
 If multiple locations listed below due to rain event, check here

7. Incident Location: (check all that apply)
- | | |
|--|--|
| <input type="checkbox"/> Plant | <input type="checkbox"/> City Collection Line (Line Break / Joint) |
| <input type="checkbox"/> Lift/Pump Station | <input type="checkbox"/> Private Sewer Line |
| <input type="checkbox"/> Peak Flow Basin | <input type="checkbox"/> Basement |
| <input checked="" type="checkbox"/> Manhole(s) | <input type="checkbox"/> Other (specify below) |

Identify **All** Incident Locations by Name, Street Address or Manhole Number as appropriate.
 Kevin Lis called and stated the manhole at 701 13th Street Terrance is holding water. The upstream M/H is 1116 and the downstream M/H is 1117.

8. Cause of Incident:
- | | |
|---|--|
| <input type="checkbox"/> Intentional Bypass for Repair/Construction | <input type="checkbox"/> Equipment Failure |
| <input type="checkbox"/> Excessive Rainfall, Snow Melt | <input type="checkbox"/> Control System Failure |
| <input type="checkbox"/> Unplanned Construction Related Break | <input type="checkbox"/> Power Related Failure |
| <input type="checkbox"/> City Line Break (Not Construction Related) | <input type="checkbox"/> Operations Related Failure |
| <input checked="" type="checkbox"/> City Line Blockage | <input type="checkbox"/> Maintenance Related Failure |
| <input type="checkbox"/> Private Line Break | <input type="checkbox"/> Vandalism |
| <input type="checkbox"/> Private Line Blockage | <input type="checkbox"/> Other |
| <input type="checkbox"/> Lagoon High Level | |

Additional explanation of reason for Incident: (use additional page if necessary)
 Our crew arrived and noticed roots in the invert. We rodded the line and hit a blockage at 30 ft.

9. Corrective Action, if any: (use additional page if necessary)
 After getting through the blockage the water receded. There was not water on the ground and all water was contained in the basement.

Name: Chuck Staples Date: 1/17/17
 Title: Superintendent Phone: 913-682-1090

When Completed, E-mail to: cseeds@kdheks.gov
 Kansas Department of Health & Environment – Attn: Chris Seeds
 Or Mail to: 1000 SW Jackson St., Suite 420, Topeka , KS 66612-1367

**KANSAS DEPARTMENT OF HEALTH AND ENVIRONMENT
WASTEWATER INCIDENT REPORT FORM**

Definitions are available at <http://www.kdheks.gov/water/tech.html>

Collection System Bypass In-Plant Diversion Upset In-Plant Flow Through Spill

1. FACILITY NAME: Leavenworth, City of Kansas Permit # M-MO12-IO01
2. Within 24 hours of discovery, notify the KDHE Central Office (email – cseeds@kdheks.gov), (fax 785.296.0086), (telephone 785.296.5517) or your local KDHE district office. Written notification is required within 5 days of discovery. If the incident is not corrected within 5 days, send a written notification to KDHE indicating the status. This form is to be sent to KDHE when the incident ends.

KDHE Person Contacted: Chris Seeds Date: 1/20/17 Time: 8:06am

3. Date Incident Discovered: 1/19/2017 Time: 3:42 pm
4. Date Incident Ended: 1/19/2017 Time: 4:47pm
5. Total estimated gallons bypassed, spilled, or routed through failed equipment for all locations on this form: 200 gallons (From basement sump pump)
6. If rainfall induced event, approximate inches of rainfall n/a
 If multiple locations listed below due to rain event, check here

7. Incident Location: (check all that apply)
- | | |
|--|--|
| <input type="checkbox"/> Plant | <input type="checkbox"/> City Collection Line (Line Break / Joint) |
| <input type="checkbox"/> Lift/Pump Station | <input type="checkbox"/> Private Sewer Line |
| <input type="checkbox"/> Peak Flow Basin | <input checked="" type="checkbox"/> Basement |
| <input checked="" type="checkbox"/> Manhole(s) | <input type="checkbox"/> Other (specify below) |

Identify **All** Incident Locations by Name, Street Address or Manhole Number as appropriate.
J.F. Denney called stating the house at 1234 Kiowa St had water coming into the basement. The upstream M/H is a new unmarked M/H and the downstream M/H is 0130.

8. Cause of Incident:
- | | |
|---|--|
| <input type="checkbox"/> Intentional Bypass for Repair/Construction | <input type="checkbox"/> Equipment Failure |
| <input type="checkbox"/> Excessive Rainfall, Snow Melt | <input type="checkbox"/> Control System Failure |
| <input type="checkbox"/> Unplanned Construction Related Break | <input type="checkbox"/> Power Related Failure |
| <input type="checkbox"/> City Line Break (Not Construction Related) | <input type="checkbox"/> Operations Related Failure |
| <input checked="" type="checkbox"/> City Line Blockage | <input type="checkbox"/> Maintenance Related Failure |
| <input type="checkbox"/> Private Line Break | <input type="checkbox"/> Vandalism |
| <input type="checkbox"/> Private Line Blockage | <input type="checkbox"/> Other |
| <input type="checkbox"/> Lagoon High Level | |

Additional explanation of reason for Incident: (use additional page if necessary)
Upon arrival the unmarked M/H was holding water. We rodded without hitting a blockage but at 412 feet the water started to recede. We continued to rod the rest of the line and still did not hit a blockage. We are going back this morning to cctv this line. We believe the backup was caused by recent construction of two M/H's on this line.

9. Corrective Action, if any: (use additional page if necessary)
We rodded to opened the line and then spread lime on the ground where the sump pump had been pumping water out of the basement until we asked the plumber to shut off the sump pump.

Name: Chuck Staples Date: 1/20/17
Title: Superintendent Phone: 913-682-1090

**KANSAS DEPARTMENT OF HEALTH AND ENVIRONMENT
WASTEWATER INCIDENT REPORT FORM**

Definitions are available at <http://www.kdheks.gov/water/tech.html>

Collection System Bypass In-Plant Diversion Upset In-Plant Flow Through Spill

1. FACILITY NAME: Leavenworth, City of Kansas Permit # M-MO12-IO01
2. Within 24 hours of discovery, notify the KDHE Central Office (email – cseeds@kdheks.gov), (fax 785.296.0086), (telephone 785.296.5517) or your local KDHE district office. Written notification is required within 5 days of discovery. If the incident is not corrected within 5 days, send a written notification to KDHE indicating the status. This form is to be sent to KDHE when the incident ends.

KDHE Person Contacted: Chris Seeds Date: 1/23/17 Time: 10:25 am

3. Date Incident Discovered: 1/20/2017 Time: 2:32 pm
4. Date Incident Ended: 1/23/2017 Time: 9:00 am
5. Total estimated gallons bypassed, spilled, or routed through failed equipment for all locations on this form: 5 gallon(contained in yard)
6. If rainfall induced event, approximate inches of rainfall n/a
If multiple locations listed below due to rain event, check here

7. Incident Location: (check all that apply)
- | | |
|--|--|
| <input type="checkbox"/> Plant | <input type="checkbox"/> City Collection Line (Line Break / Joint) |
| <input type="checkbox"/> Lift/Pump Station | <input checked="" type="checkbox"/> Private Sewer Line |
| <input type="checkbox"/> Peak Flow Basin | <input type="checkbox"/> Basement |
| <input type="checkbox"/> Manhole(s) | <input type="checkbox"/> Other (specify below) |

Identify All Incident Locations by Name, Street Address or Manhole Number as appropriate.
We were called by a neighbor stating that the lateral had been overflowing at 312 Pine Street. The upstream M/H is 0713 and the downstream is 0714.

8. Cause of Incident:
- | | |
|---|--|
| <input type="checkbox"/> Intentional Bypass for Repair/Construction | <input type="checkbox"/> Equipment Failure |
| <input type="checkbox"/> Excessive Rainfall, Snow Melt | <input type="checkbox"/> Control System Failure |
| <input type="checkbox"/> Unplanned Construction Related Break | <input type="checkbox"/> Power Related Failure |
| <input type="checkbox"/> City Line Break (Not Construction Related) | <input type="checkbox"/> Operations Related Failure |
| <input type="checkbox"/> City Line Blockage | <input type="checkbox"/> Maintenance Related Failure |
| <input type="checkbox"/> Private Line Break | <input type="checkbox"/> Vandalism |
| <input checked="" type="checkbox"/> Private Line Blockage | <input type="checkbox"/> Other |
| <input type="checkbox"/> Lagoon High Level | |

Additional explanation of reason for Incident: (use additional page if necessary)
Our crew checked our line and the flow was good. We did rod 110 feet and could not get through. Since no one was home we contacted our plumbing inspector and he said he would leave a letter or try to make contact.

9. Corrective Action, if any: (use additional page if necessary)
After notifying the inspector we placed containment socks around the cleanout. We have scheduled our camera crew to check this line to see why we could not the the cleaning nozzle through. Water is flowing normal.

Name: Chuck Staples Date: _____
Title: Superintendent Phone 913-682-1090



SANITARY SEWER OVRFLOWS

FEBRUARY 2017



**KANSAS DEPARTMENT OF HEALTH AND ENVIRONMENT
WASTEWATER INCIDENT REPORT FORM**

Definitions are available at <http://www.kdheks.gov/water/tech.html>

Collection System Bypass In-Plant Diversion Upset In-Plant Flow Through Spill

1. FACILITY NAME: Leavenworth, City of Kansas Permit # M-MO12-IO01
2. Within 24 hours of discovery, notify the KDHE Central Office (email – cseeds@kdheks.gov), (fax 785.296.0086), (telephone 785.296.5517) or your local KDHE district office. Written notification is required within 5 days of discovery. If the incident is not corrected within 5 days, send a written notification to KDHE indicating the status. This form is to be sent to KDHE when the incident ends.

KDHE Person Contacted: Chris Seeds Date: 2/3/17 Time: 10:56 am

3. Date Incident Discovered: 2/3/2017 Time: 9:15 am
4. Date Incident Ended: 2/3/2017 Time: 10:15 am
5. Total estimated gallons bypassed, spilled, or routed through failed equipment for all locations on this form: 2 gallons
6. If rainfall induced event, approximate inches of rainfall n/a
 If multiple locations listed below due to rain event, check here

7. Incident Location: (check all that apply)
- | | |
|--|--|
| <input type="checkbox"/> Plant | <input type="checkbox"/> City Collection Line (Line Break / Joint) |
| <input type="checkbox"/> Lift/Pump Station | <input type="checkbox"/> Private Sewer Line |
| <input type="checkbox"/> Peak Flow Basin | <input type="checkbox"/> Basement |
| <input checked="" type="checkbox"/> Manhole(s) | <input type="checkbox"/> Other (specify below) |

Identify All Incident Locations by Name, Street Address or Manhole Number as appropriate.
Aaron Frickie called statin the water was flowing out of the manhole next to his house at 510 Isabell St. The upstream M/H is 0601(Flush tank) and the downstream M/H is 0600.

8. Cause of Incident:
- | | |
|---|--|
| <input type="checkbox"/> Intentional Bypass for Repair/Construction | <input type="checkbox"/> Equipment Failure |
| <input type="checkbox"/> Excessive Rainfall, Snow Melt | <input type="checkbox"/> Control System Failure |
| <input type="checkbox"/> Unplanned Construction Related Break | <input type="checkbox"/> Power Related Failure |
| <input type="checkbox"/> City Line Break (Not Construction Related) | <input type="checkbox"/> Operations Related Failure |
| <input checked="" type="checkbox"/> City Line Blockage | <input type="checkbox"/> Maintenance Related Failure |
| <input type="checkbox"/> Private Line Break | <input type="checkbox"/> Vandalism |
| <input type="checkbox"/> Private Line Blockage | <input type="checkbox"/> Other |
| <input type="checkbox"/> Lagoon High Level | |

Additional explanation of reason for Incident: (use additional page if necessary)
Upon arrival the upstream M/H had leaked some water but was not leaking at this time. We opened the M/H and found it to be mostly full. We rodded and hit a blockage about a foot in from the downstream M/H and the water receded. This is a City line issue.

9. Corrective Action, if any: (use additional page if necessary)
Once the water receded we rodded as close to the flush tanks as we could (100 feet). We did not hit any other blockage in the line. We will have this M/H cctv'd to see what caused this backup.

Name: Chuck Staples Date: 2/03/17
Title: Superintendent Phone: 913-682-1090

When Completed, E-mail to: cseeds@kdheks.gov

**KANSAS DEPARTMENT OF HEALTH AND ENVIRONMENT
WASTEWATER INCIDENT REPORT FORM**

Definitions are available at <http://www.kdheks.gov/water/tech.html>

Collection System Bypass In-Plant Diversion Upset In-Plant Flow Through Spill

1. FACILITY NAME: Leavenworth, City of Kansas Permit # M-MO12-IO01
2. Within 24 hours of discovery, notify the KDHE Central Office (email – cseeds@kdheks.gov), (fax 785.296.0086), (telephone 785.296.5517) or your local KDHE district office. Written notification is required within 5 days of discovery. If the incident is not corrected within 5 days, send a written notification to KDHE indicating the status. This form is to be sent to KDHE when the incident ends.

KDHE Person Contacted: Chris Seeds Date: 2/17/17 Time: 11:59 am

3. Date Incident Discovered: 2/16/2017 Time: 3:00 pm
4. Date Incident Ended: 2/16/2017 Time: 3:15 pm
5. Total estimated gallons bypassed, spilled, or routed through failed equipment for all locations on this form: 2 gallons
6. If rainfall induced event, approximate inches of rainfall n/a
If multiple locations listed below due to rain event, check here

7. Incident Location: (check all that apply)
- | | |
|--|--|
| <input type="checkbox"/> Plant | <input type="checkbox"/> City Collection Line (Line Break / Joint) |
| <input type="checkbox"/> Lift/Pump Station | <input checked="" type="checkbox"/> Private Sewer Line |
| <input type="checkbox"/> Peak Flow Basin | <input type="checkbox"/> Basement |
| <input type="checkbox"/> Manhole(s) | <input type="checkbox"/> Other (specify below) |

Identify **All** Incident Locations by Name, Street Address or Manhole Number as appropriate. The neighbor of 312 Pine Street called stating that the lateral at 312 Pine was overflowing. The upstream M/H is 0713 and the down stream is 0714

8. Cause of Incident:
- | | |
|---|--|
| <input type="checkbox"/> Intentional Bypass for Repair/Construction | <input type="checkbox"/> Equipment Failure |
| <input type="checkbox"/> Excessive Rainfall, Snow Melt | <input type="checkbox"/> Control System Failure |
| <input type="checkbox"/> Unplanned Construction Related Break | <input type="checkbox"/> Power Related Failure |
| <input type="checkbox"/> City Line Break (Not Construction Related) | <input type="checkbox"/> Operations Related Failure |
| <input type="checkbox"/> City Line Blockage | <input type="checkbox"/> Maintenance Related Failure |
| <input type="checkbox"/> Private Line Break | <input type="checkbox"/> Vandalism |
| <input checked="" type="checkbox"/> Private Line Blockage | <input type="checkbox"/> Other |
| <input type="checkbox"/> Lagoon High Level | |

Additional explanation of reason for Incident: (use additional page if necessary)
After we checked our lines and had good flow we contacted or inspection branch to follow up on getting this lateral cleaned out.

9. Corrective Action, if any: (use additional page if necessary)
After contacting our inspection branch we placed containment socks around the lateral.

Name: Chuck Staples Date: 2/17/17
Title: Superintendent Phone: 913-682-1090

When Completed, E-mail to: cseeds@kdheks.gov
Kansas Department of Health & Environment – Attn: Chris Seeds
Or Mail to: 1000 SW Jackson St., Suite 420, Topeka , KS 66612-1367

**KANSAS DEPARTMENT OF HEALTH AND ENVIRONMENT
WASTEWATER INCIDENT REPORT FORM**

Definitions are available at <http://www.kdheks.gov/water/tech.html>

Collection System Bypass In-Plant Diversion Upset In-Plant Flow Through Spill

1. FACILITY NAME: Leavenworth, City of Kansas Permit # M-MO12-IO01
2. Within 24 hours of discovery, notify the KDHE Central Office (email – cseeds@kdheks.gov), (fax 785.296.0086), (telephone 785.296.5517) or your local KDHE district office. Written notification is required within 5 days of discovery. If the incident is not corrected within 5 days, send a written notification to KDHE indicating the status. This form is to be sent to KDHE when the incident ends.

KDHE Person Contacted: Chris Seeds Date: 2/21/17 Time: 8:32 am

3. Date Incident Discovered: 2/15/2017 Time: 12:40 pm
4. Date Incident Ended: 2/17/2017 Time: 5:00pm
5. Total estimated gallons bypassed, spilled, or routed through failed equipment for all locations on this form: unknown(contained in yard)
6. If rainfall induced event, approximate inches of rainfall n/a
 If multiple locations listed below due to rain event, check here

7. Incident Location: (check all that apply)
- | | |
|--|--|
| <input type="checkbox"/> Plant | <input type="checkbox"/> City Collection Line (Line Break / Joint) |
| <input type="checkbox"/> Lift/Pump Station | <input checked="" type="checkbox"/> Private Sewer Line |
| <input type="checkbox"/> Peak Flow Basin | <input type="checkbox"/> Basement |
| <input type="checkbox"/> Manhole(s) | <input type="checkbox"/> Other (specify below) |

Identify All Incident Locations by Name, Street Address or Manhole Number as appropriate.
We were performing a utility locate and noticed sewage leaking onto the ground at 622 west 7th street. The upstream M/H is 0326.1 and the downstream M/H is 0326.

8. Cause of Incident:
- | | |
|---|--|
| <input type="checkbox"/> Intentional Bypass for Repair/Construction | <input type="checkbox"/> Equipment Failure |
| <input type="checkbox"/> Excessive Rainfall, Snow Melt | <input type="checkbox"/> Control System Failure |
| <input type="checkbox"/> Unplanned Construction Related Break | <input type="checkbox"/> Power Related Failure |
| <input type="checkbox"/> City Line Break (Not Construction Related) | <input type="checkbox"/> Operations Related Failure |
| <input type="checkbox"/> City Line Blockage | <input type="checkbox"/> Maintenance Related Failure |
| <input checked="" type="checkbox"/> Private Line Break | <input type="checkbox"/> Vandalism |
| <input type="checkbox"/> Private Line Blockage | <input type="checkbox"/> Other |
| <input type="checkbox"/> Lagoon High Level | |

Additional explanation of reason for Incident: (use additional page if necessary)
After checking the city lines and having no problems we contacted the owner and our plumbing inspector. We placed containment socks around the cleanout and applied lime on the area.

9. Corrective Action, if any: (use additional page if necessary)
Our plumbing inspector contacted the owner and informed them they needed to call a plumber. I was contacted this morning and informed the repairs were approved and made Friday 2/17/17 around 5:00pm

Name: Chuck Staples Date: 2/21/17
Title: Superintendent Phone: 913-682-1090

When Completed, E-mail to: cseeds@kdheks.gov

**KANSAS DEPARTMENT OF HEALTH AND ENVIRONMENT
WASTEWATER INCIDENT REPORT FORM**

Definitions are available at <http://www.kdheks.gov/water/tech.html>

Collection System Bypass In-Plant Diversion Upset In-Plant Flow Through Spill

1. FACILITY NAME: Leavenworth, City of Kansas Permit # M-MO12-IO01

2. Within 24 hours of discovery, notify the KDHE Central Office (email – cseeds@kdheks.gov), (fax 785.296.0086), (telephone 785.296.5517) or your local KDHE district office. Written notification is required within 5 days of discovery. If the incident is not corrected within 5 days, send a written notification to KDHE indicating the status. This form is to be sent to KDHE when the incident ends.

KDHE Person Contacted: Chris Seeds Date: 2/21/17 Time: 9:56 am

3. Date Incident Discovered: 2/18/2017 Time: 2:14 pm

4. Date Incident Ended: 2/21/2017 Time: 8:00 am

5. Total estimated gallons bypassed, spilled, or routed through failed equipment for all locations on this form: 300 gallons(some water ran into a storm drain)

6. If rainfall induced event, approximate inches of rainfall n/a

If multiple locations listed below due to rain event, check here

7. Incident Location: (check all that apply)

- | | |
|--|--|
| <input type="checkbox"/> Plant | <input type="checkbox"/> City Collection Line (Line Break / Joint) |
| <input type="checkbox"/> Lift/Pump Station | <input checked="" type="checkbox"/> Private Sewer Line |
| <input type="checkbox"/> Peak Flow Basin | <input type="checkbox"/> Basement |
| <input type="checkbox"/> Manhole(s) | <input type="checkbox"/> Other (specify below) |

Identify **All** Incident Locations by Name, Street Address or Manhole Number as appropriate.

The owner of the rental property Norris Simmons called stating that their lateral was overflowing at 804 south 4th street. This a private line that dump into manhole 1004.

8. Cause of Incident:

- | | |
|---|--|
| <input type="checkbox"/> Intentional Bypass for Repair/Construction | <input type="checkbox"/> Equipment Failure |
| <input type="checkbox"/> Excessive Rainfall, Snow Melt | <input type="checkbox"/> Control System Failure |
| <input type="checkbox"/> Unplanned Construction Related Break | <input type="checkbox"/> Power Related Failure |
| <input type="checkbox"/> City Line Break (Not Construction Related) | <input type="checkbox"/> Operations Related Failure |
| <input type="checkbox"/> City Line Blockage | <input type="checkbox"/> Maintenance Related Failure |
| <input type="checkbox"/> Private Line Break | <input type="checkbox"/> Vandalism |
| <input checked="" type="checkbox"/> Private Line Blockage | <input type="checkbox"/> Other |
| <input type="checkbox"/> Lagoon High Level | |

Additional explanation of reason for Incident: (use additional page if necessary)

Upon arrival the clean out at the above address was overflowing and water was ponding around the house and running across the alley into a storm drain. We asked the residents to shut off their water and when they did the water stopped overflowing.

9. Corrective Action, if any: (use additional page if necessary)

I contacted the owner and informed him that he needed to call a plumber and he said he had one on the way. We vactored up the water and placed containment socks around the cleanout.

Name: Chuck Staples

Date: 2/21/17

Title: Superintendent

Phone: 913-682-1090

When Completed, E-mail to: cseeds@kdheks.gov

**KANSAS DEPARTMENT OF HEALTH AND ENVIRONMENT
WASTEWATER INCIDENT REPORT FORM**

Definitions are available at <http://www.kdheks.gov/water/tech.html>

Collection System Bypass In-Plant Diversion Upset In-Plant Flow Through Spill

1. FACILITY NAME: Leavenworth, City of Kansas Permit # M-MO12-IO01
2. Within 24 hours of discovery, notify the KDHE Central Office (email – cseeds@kdheks.gov), (fax 785.296.0086), (telephone 785.296.5517) or your local KDHE district office. Written notification is required within 5 days of discovery. If the incident is not corrected within 5 days, send a written notification to KDHE indicating the status. This form is to be sent to KDHE when the incident ends.

KDHE Person Contacted: Chris Seeds Date: 3/1/17 Time: 7:50 AM

3. Date Incident Discovered: 2/21/2017 Time: 1:50 PM

4. Date Incident Ended: 2/28/2017 Time: 3:00 PM

5. Total estimated gallons bypassed, spilled, or routed through failed equipment for all locations on this form: 10 GALLONS (Water was shut off)

6. If rainfall induced event, approximate inches of rainfall n/a

If multiple locations listed below due to rain event, check here

7. Incident Location: (check all that apply)

- | | |
|--|--|
| <input type="checkbox"/> Plant | <input type="checkbox"/> City Collection Line (Line Break / Joint) |
| <input type="checkbox"/> Lift/Pump Station | <input checked="" type="checkbox"/> Private Sewer Line |
| <input type="checkbox"/> Peak Flow Basin | <input type="checkbox"/> Basement |
| <input type="checkbox"/> Manhole(s) | <input type="checkbox"/> Other (specify below) |

Identify **All** Incident Locations by Name, Street Address or Manhole Number as appropriate.

Mr. Warren called stating that water was running out of a hole next to his house at 625 Dakota Street. The upstream manhole is 0095.1 and the downstream manhole is 0094.2

8. Cause of Incident:

- | | |
|---|--|
| <input type="checkbox"/> Intentional Bypass for Repair/Construction | <input type="checkbox"/> Equipment Failure |
| <input type="checkbox"/> Excessive Rainfall, Snow Melt | <input type="checkbox"/> Control System Failure |
| <input type="checkbox"/> Unplanned Construction Related Break | <input type="checkbox"/> Power Related Failure |
| <input type="checkbox"/> City Line Break (Not Construction Related) | <input type="checkbox"/> Operations Related Failure |
| <input type="checkbox"/> City Line Blockage | <input type="checkbox"/> Maintenance Related Failure |
| <input type="checkbox"/> Private Line Break | <input type="checkbox"/> Vandalism |
| <input checked="" type="checkbox"/> Private Line Blockage | <input type="checkbox"/> Other |
| <input type="checkbox"/> Lagoon High Level | |

Additional explanation of reason for Incident: (use additional page if necessary)

Our crew arrived and checked the City main and had no problems. The cleanout next to Mr. Warren house was overflowing and we informed him he needed to call a plumber.

9. Corrective Action, if any: (use additional page if necessary)

Before we left we placed containment socks around the clean out and informed Mr. Warren that we would turn this over to our inspection branch and he would be allowed a couple of days to get this cleaned out and we asked him to limit his water use. The City sent a letter that his water would be shut off if he did not get his lateral opened up. Mr. Warren did not get his lateral opened so at 3:00 pm on the 2/28/17 his water was shut off.

Name: Chuck Staples Date: 3/01/17
Title: Superintendent Phone: 913-682-1090

**KANSAS DEPARTMENT OF HEALTH AND ENVIRONMENT
WASTEWATER INCIDENT REPORT FORM**

Definitions are available at <http://www.kdheks.gov/water/tech.html>

Collection System Bypass In-Plant Diversion Upset In-Plant Flow Through Spill

1. FACILITY NAME: Leavenworth, City of Kansas Permit # M-MO12-IO01
2. Within 24 hours of discovery, notify the KDHE Central Office (email – cseeds@kdheks.gov), (fax 785.296.0086), (telephone 785.296.5517) or your local KDHE district office. Written notification is required within 5 days of discovery. If the incident is not corrected within 5 days, send a written notification to KDHE indicating the status. This form is to be sent to KDHE when the incident ends.

KDHE Person Contacted: Chris Seeds Date: 2/22/17 Time: 3:51 pm

3. Date Incident Discovered: 2/22/2017 Time: 9:00 am

4. Date Incident Ended: 2/22/2017 Time: 1:30 pm

5. Total estimated gallons bypassed, spilled, or routed through failed equipment for all locations on this form: 2 gallons

6. If rainfall induced event, approximate inches of rainfall n/a

If multiple locations listed below due to rain event, check here

7. Incident Location: (check all that apply)

- | | |
|--|---|
| <input type="checkbox"/> Plant | <input checked="" type="checkbox"/> City Collection Line (Line Break / Joint) |
| <input type="checkbox"/> Lift/Pump Station | <input type="checkbox"/> Private Sewer Line |
| <input type="checkbox"/> Peak Flow Basin | <input type="checkbox"/> Basement |
| <input type="checkbox"/> Manhole(s) | <input type="checkbox"/> Other (specify below) |

Identify **All** Incident Locations by Name, Street Address or Manhole Number as appropriate. During a routine contract for changing the VCP line in the creek at 1512 Osage St the contractor noticed the VCP line had been leaking. This line was being changed from VCP to ductile iron which is better suited for a creek crossing.

8. Cause of Incident:

- | | |
|--|--|
| <input checked="" type="checkbox"/> Intentional Bypass for Repair/Construction | <input type="checkbox"/> Equipment Failure |
| <input type="checkbox"/> Excessive Rainfall, Snow Melt | <input type="checkbox"/> Control System Failure |
| <input type="checkbox"/> Unplanned Construction Related Break | <input type="checkbox"/> Power Related Failure |
| <input checked="" type="checkbox"/> City Line Break (Not Construction Related) | <input type="checkbox"/> Operations Related Failure |
| <input type="checkbox"/> City Line Blockage | <input type="checkbox"/> Maintenance Related Failure |
| <input type="checkbox"/> Private Line Break | <input type="checkbox"/> Vandalism |
| <input type="checkbox"/> Private Line Blockage | <input type="checkbox"/> Other |
| <input type="checkbox"/> Lagoon High Level | |

Additional explanation of reason for Incident: (use additional page if necessary)

This line was already bypassed by the contractor when they noticed it had been leaking. We had placed contaminated Creek sign out and we will take e-coli samples and remove the sign when the levels are back to normal. Just a small amount of sanitary sewer water was spilled into the creek.

9. Corrective Action, if any: (use additional page if necessary)

The line was removed and new ductile iron was installed as a planned contract. This line was repaired and back in service at 1:30 pm on the 22nd

Name: Chuck Staples Date: 2/22/17
Title: Superintendent Phone: 913-682-1090

SANITARY SEWER OVRFLOWS

MARCH 2017

**KANSAS DEPARTMENT OF HEALTH AND ENVIRONMENT
WASTEWATER INCIDENT REPORT FORM**

Definitions are available at <http://www.kdheks.gov/water/tech.html>

Collection System Bypass In-Plant Diversion Upset In-Plant Flow Through Spill

1. FACILITY NAME: Leavenworth, City of Kansas Permit # M-MO12-IO01
2. Within 24 hours of discovery, notify the KDHE Central Office (email – cseeds@kdheks.gov), (fax 785.296.0086), (telephone 785.296.5517) or your local KDHE district office. Written notification is required within 5 days of discovery. If the incident is not corrected within 5 days, send a written notification to KDHE indicating the status. This form is to be sent to KDHE when the incident ends.

KDHE Person Contacted: Chris Seeds Date: 3/3/17 Time: 7:39 am

3. Date Incident Discovered: 3/2/2017 Time: 9:30 am

4. Date Incident Ended: 3/2/2017 Time: 11:30 am

5. Total estimated gallons bypassed, spilled, or routed through failed equipment for all locations on this form: 5 gallons(contained in yard)

6. If rainfall induced event, approximate inches of rainfall n/a

If multiple locations listed below due to rain event, check here

7. Incident Location: (check all that apply)

- | | |
|--|--|
| <input type="checkbox"/> Plant | <input type="checkbox"/> City Collection Line (Line Break / Joint) |
| <input type="checkbox"/> Lift/Pump Station | <input checked="" type="checkbox"/> Private Sewer Line |
| <input type="checkbox"/> Peak Flow Basin | <input type="checkbox"/> Basement |
| <input type="checkbox"/> Manhole(s) | <input type="checkbox"/> Other (specify below) |

Identify **All** Incident Locations by Name, Street Address or Manhole Number as appropriate.

Mark Kramer our plumbing inspector called stating that the lateral at 415 Vine st was overflowing into the yard. The upstream manhole is 0585 and the downstream manhole is 0712.

8. Cause of Incident:

- | | |
|---|--|
| <input type="checkbox"/> Intentional Bypass for Repair/Construction | <input type="checkbox"/> Equipment Failure |
| <input type="checkbox"/> Excessive Rainfall, Snow Melt | <input type="checkbox"/> Control System Failure |
| <input type="checkbox"/> Unplanned Construction Related Break | <input type="checkbox"/> Power Related Failure |
| <input type="checkbox"/> City Line Break (Not Construction Related) | <input type="checkbox"/> Operations Related Failure |
| <input type="checkbox"/> City Line Blockage | <input type="checkbox"/> Maintenance Related Failure |
| <input type="checkbox"/> Private Line Break | <input type="checkbox"/> Vandalism |
| <input checked="" type="checkbox"/> Private Line Blockage | <input type="checkbox"/> Other |
| <input type="checkbox"/> Lagoon High Level | |

Additional explanation of reason for Incident: (use additional page if necessary)

The private lateral was blocked

9. Corrective Action, if any: (use additional page if necessary)

Once we checked our lines we placed containment socks around the lateral and spread lime on the ground. The City inspector had already left a note asking the owner to call a plumber. We were called that the line was opened around 11:30 am

Name: Chuck Staples

Date: _____

Title: Superintendent

Phone: 913-682-1090

When Completed, E-mail to: cseeds@kdheks.gov

Kansas Department of Health & Environment – Attn: Chris Seeds

**KANSAS DEPARTMENT OF HEALTH AND ENVIRONMENT
WASTEWATER INCIDENT REPORT FORM**

Definitions are available at <http://www.kdheks.gov/water/tech.html>

Collection System Bypass In-Plant Diversion Upset In-Plant Flow Through Spill

1. FACILITY NAME: Leavenworth, City of Kansas Permit # M-MO12-IO01
2. Within 24 hours of discovery, notify the KDHE Central Office (email – cseeds@kdheks.gov), (fax 785.296.0086), (telephone 785.296.5517) or your local KDHE district office. Written notification is required within 5 days of discovery. If the incident is not corrected within 5 days, send a written notification to KDHE indicating the status. This form is to be sent to KDHE when the incident ends.

KDHE Person Contacted: Chris Seeds Date: 3/3/17 Time: 7:58

3. Date Incident Discovered: 3/2/2017 Time: 12:30 pm

4. Date Incident Ended: 3/2/2017 Time: 2:01pm

5. Total estimated gallons bypassed, spilled, or routed through failed equipment for all locations on this form: Less than one gallon

6. If rainfall induced event, approximate inches of rainfall n/a

If multiple locations listed below due to rain event, check here

7. Incident Location: (check all that apply)

- | | |
|--|--|
| <input type="checkbox"/> Plant | <input type="checkbox"/> City Collection Line (Line Break / Joint) |
| <input type="checkbox"/> Lift/Pump Station | <input type="checkbox"/> Private Sewer Line |
| <input type="checkbox"/> Peak Flow Basin | <input type="checkbox"/> Basement |
| <input type="checkbox"/> Manhole(s) | <input checked="" type="checkbox"/> Other (specify below) |

Identify **All** Incident Locations by Name, Street Address or Manhole Number as appropriate. While cleaning the sewer line at 2613 south 4th street water was forced back through the owners lateral and came out of the toilet in her bathroom. The upstream manhole is 0669 and the downstream manhole is 0667

8. Cause of Incident:

- | | |
|---|--|
| <input type="checkbox"/> Intentional Bypass for Repair/Construction | <input type="checkbox"/> Equipment Failure |
| <input type="checkbox"/> Excessive Rainfall, Snow Melt | <input type="checkbox"/> Control System Failure |
| <input type="checkbox"/> Unplanned Construction Related Break | <input type="checkbox"/> Power Related Failure |
| <input type="checkbox"/> City Line Break (Not Construction Related) | <input type="checkbox"/> Operations Related Failure |
| <input type="checkbox"/> City Line Blockage | <input type="checkbox"/> Maintenance Related Failure |
| <input type="checkbox"/> Private Line Break | <input type="checkbox"/> Vandalism |
| <input type="checkbox"/> Private Line Blockage | <input checked="" type="checkbox"/> Other |
| <input type="checkbox"/> Lagoon High Level | |

Additional explanation of reason for Incident: (use additional page if necessary)

Our crew was cleaning a line to clean decaying roots from line from last years root treatment. As we were cleaning this line water was forced up the lateral and came out of her toilet. This is mainly due to the configuration of the owners lateral which comes into the main low and level.

9. Corrective Action, if any: (use additional page if necessary)

We have placed this address on a list we maintain so when we clean this line again we lower the pressure in the cleaning hose.

Name: Chuck Staples Date: 3/03/17
Title: Superintendent Phone: 913-682-1090

**KANSAS DEPARTMENT OF HEALTH AND ENVIRONMENT
WASTEWATER INCIDENT REPORT FORM**

Definitions are available at <http://www.kdheks.gov/water/tech.html>

Collection System Bypass In-Plant Diversion Upset In-Plant Flow Through Spill

1. FACILITY NAME: Leavenworth, City of Kansas Permit # M-MO12-IO01
2. Within 24 hours of discovery, notify the KDHE Central Office (email – cseeds@kdheks.gov), (fax 785.296.0086), (telephone 785.296.5517) or your local KDHE district office. Written notification is required within 5 days of discovery. If the incident is not corrected within 5 days, send a written notification to KDHE indicating the status. This form is to be sent to KDHE when the incident ends.

KDHE Person Contacted: Chris Seeds Date: 3/13/17 Time: 11:39 am

3. Date Incident Discovered: 3/8/2017 Time: 3:30 pm
4. Date Incident Ended: 3/11/2017 Time: 5:00 pm
5. Total estimated gallons bypassed, spilled, or routed through failed equipment for all locations on this form: unknown(contained in basement)
6. If rainfall induced event, approximate inches of rainfall n/a

If multiple locations listed below due to rain event, check here

7. Incident Location: (check all that apply)

- | | |
|--|--|
| <input type="checkbox"/> Plant | <input type="checkbox"/> City Collection Line (Line Break / Joint) |
| <input type="checkbox"/> Lift/Pump Station | <input checked="" type="checkbox"/> Private Sewer Line |
| <input type="checkbox"/> Peak Flow Basin | <input checked="" type="checkbox"/> Basement |
| <input type="checkbox"/> Manhole(s) | <input type="checkbox"/> Other (specify below) |

Identify **All** Incident Locations by Name, Street Address or Manhole Number as appropriate. The owner Ron called stating he had water backing up in his basement at 787 Pennsylvania st. The upstream M/H is 0492 and the downstream M/H is 0492.2

8. Cause of Incident:

- | | |
|---|--|
| <input type="checkbox"/> Intentional Bypass for Repair/Construction | <input type="checkbox"/> Equipment Failure |
| <input type="checkbox"/> Excessive Rainfall, Snow Melt | <input type="checkbox"/> Control System Failure |
| <input type="checkbox"/> Unplanned Construction Related Break | <input type="checkbox"/> Power Related Failure |
| <input type="checkbox"/> City Line Break (Not Construction Related) | <input type="checkbox"/> Operations Related Failure |
| <input type="checkbox"/> City Line Blockage | <input type="checkbox"/> Maintenance Related Failure |
| <input type="checkbox"/> Private Line Break | <input type="checkbox"/> Vandalism |
| <input checked="" type="checkbox"/> Private Line Blockage | <input type="checkbox"/> Other |
| <input type="checkbox"/> Lagoon High Level | |

Additional explanation of reason for Incident: (use additional page if necessary)

Upon arrival our crew checked the flow in the City line and there was good flow. There was water in the basement and the owner said the line was backing up for 3 days.

9. Corrective Action, if any: (use additional page if necessary)

With the City line flowing good we informed the owner that he needed to call a plumber. I talked to the owner this morning and the line is open and water had drained, but the private line is partially collapsed. They are getting bids for the repair.

Name: Chuck Staples Date: _____

Title: Superintendent Phone: 913-682-1090

When Completed, E-mail to: cseeds@kdheks.gov

**KANSAS DEPARTMENT OF HEALTH AND ENVIRONMENT
WASTEWATER INCIDENT REPORT FORM**

Definitions are available at <http://www.kdheks.gov/water/tech.html>

Collection System Bypass In-Plant Diversion Upset In-Plant Flow Through Spill

1. FACILITY NAME: Leavenworth, City of Kansas Permit # M-MO12-IO01
2. Within 24 hours of discovery, notify the KDHE Central Office (email – cseeds@kdheks.gov), (fax 785.296.0086), (telephone 785.296.5517) or your local KDHE district office. Written notification is required within 5 days of discovery. If the incident is not corrected within 5 days, send a written notification to KDHE indicating the status. This form is to be sent to KDHE when the incident ends.

KDHE Person Contacted: Chris Seeds Date: 3/13/17 Time: 8:20 am

3. Date Incident Discovered: 3/12/2017 Time: 4:00 pm

4. Date Incident Ended: 3/14/2017 Time: 7:00 am

5. Total estimated gallons bypassed, spilled, or routed through failed equipment for all locations on this form: unknown(contained in basement)

6. If rainfall induced event, approximate inches of rainfall n/a

If multiple locations listed below due to rain event, check here

7. Incident Location: (check all that apply)

- | | |
|--|--|
| <input type="checkbox"/> Plant | <input type="checkbox"/> City Collection Line (Line Break / Joint) |
| <input type="checkbox"/> Lift/Pump Station | <input checked="" type="checkbox"/> Private Sewer Line |
| <input type="checkbox"/> Peak Flow Basin | <input checked="" type="checkbox"/> Basement |
| <input type="checkbox"/> Manhole(s) | <input type="checkbox"/> Other (specify below) |

Identify **All** Incident Locations by Name, Street Address or Manhole Number as appropriate.

Valerie Tugee called stating that water was backing up in her basement at 1206 Klemp. The upstream M/H is 0446 and the downstream M/H is 0445.

8. Cause of Incident:

- | | |
|---|--|
| <input type="checkbox"/> Intentional Bypass for Repair/Construction | <input type="checkbox"/> Equipment Failure |
| <input type="checkbox"/> Excessive Rainfall, Snow Melt | <input type="checkbox"/> Control System Failure |
| <input type="checkbox"/> Unplanned Construction Related Break | <input type="checkbox"/> Power Related Failure |
| <input type="checkbox"/> City Line Break (Not Construction Related) | <input type="checkbox"/> Operations Related Failure |
| <input type="checkbox"/> City Line Blockage | <input type="checkbox"/> Maintenance Related Failure |
| <input type="checkbox"/> Private Line Break | <input type="checkbox"/> Vandalism |
| <input checked="" type="checkbox"/> Private Line Blockage | <input type="checkbox"/> Other |
| <input type="checkbox"/> Lagoon High Level | |

Additional explanation of reason for Incident: (use additional page if necessary)

Our crew arrived and checked the Cities line and found good flow. We also cleaned the line for 245 feet and did not hit any blockage. We also found that the basement at the above address was holding water. This is a private line issue.

9. Corrective Action, if any: (use additional page if necessary)

Once our crew checked our line we informed the owner that they needed to call a plumber to open up their lateral. We informed the owner that we would contact our plumbing inspector to follow up on situation.

Name: Chuck Staples Date: 3/13/17
Title: Superintendent Phone: 913-682-1090

**KANSAS DEPARTMENT OF HEALTH AND ENVIRONMENT
WASTEWATER INCIDENT REPORT FORM**

Definitions are available at <http://www.kdheks.gov/water/tech.html>

Collection System Bypass In-Plant Diversion Upset In-Plant Flow Through Spill

1. FACILITY NAME: Leavenworth, City of Kansas Permit # M-MO12-IO01
 2. Within 24 hours of discovery, notify the KDHE Central Office (email – cseeds@kdheks.gov), (fax 785.296.0086), (telephone 785.296.5517) or your local KDHE district office. Written notification is required within 5 days of discovery. If the incident is not corrected within 5 days, send a written notification to KDHE indicating the status. This form is to be sent to KDHE when the incident ends.

KDHE Person Contacted: Chris Seeds Date: 3/15/17 Time: 1:36 pm

3. Date Incident Discovered: 3/15/2017 Time: 11:00 pm
 4. Date Incident Ended: 3/15/2017 Time: 12:35PM
 5. Total estimated gallons bypassed, spilled, or routed through failed equipment for all locations on this form: unknown(contained in basement)
 6. If rainfall induced event, approximate inches of rainfall n/a

If multiple locations listed below due to rain event, check here

7. Incident Location: (check all that apply)
- | | |
|--|--|
| <input type="checkbox"/> Plant | <input type="checkbox"/> City Collection Line (Line Break / Joint) |
| <input type="checkbox"/> Lift/Pump Station | <input checked="" type="checkbox"/> Private Sewer Line |
| <input type="checkbox"/> Peak Flow Basin | <input type="checkbox"/> Basement |
| <input type="checkbox"/> Manhole(s) | <input type="checkbox"/> Other (specify below) |

Identify **All** Incident Locations by Name, Street Address or Manhole Number as appropriate.
Martin Simpson called stating that sewer was backing up in her backyard at 733 Kickapoo. The upstream M/H is 0152.3 and the downstream is 0151. This is a private line issue.

8. Cause of Incident:
- | | |
|---|--|
| <input type="checkbox"/> Intentional Bypass for Repair/Construction | <input type="checkbox"/> Equipment Failure |
| <input type="checkbox"/> Excessive Rainfall, Snow Melt | <input type="checkbox"/> Control System Failure |
| <input type="checkbox"/> Unplanned Construction Related Break | <input type="checkbox"/> Power Related Failure |
| <input type="checkbox"/> City Line Break (Not Construction Related) | <input type="checkbox"/> Operations Related Failure |
| <input type="checkbox"/> City Line Blockage | <input type="checkbox"/> Maintenance Related Failure |
| <input type="checkbox"/> Private Line Break | <input type="checkbox"/> Vandalism |
| <input checked="" type="checkbox"/> Private Line Blockage | <input type="checkbox"/> Other |
| <input type="checkbox"/> Lagoon High Level | |

Additional explanation of reason for Incident: (use additional page if necessary)
Our crew arrived and we had good flow and no manholes were backed up. We rodded 400 feet and did a blockage at 30 and 100 feet. Since we had no water backed up our cleaning nozzle had opened up the end of the owners lateral because our crew noticed a large amount of rags and grease.

9. Corrective Action, if any: (use additional page if necessary)
After cleaning the line we contacted the owner to see if the toilet was flushing okay. The owner flushed the toilet and it was flushing normal.

Name: Chuck Staples Date: 3/15/17
 Title: Superintendent Phone: 913-682-1090

When Completed, E-mail to: cseeds@kdheks.gov

KANSAS DEPARTMENT OF HEALTH AND ENVIRONMENT
WASTEWATER INCIDENT REPORT FORM

KDHE
sent
3/21/17

Definitions are available at <http://www.kdheks.gov/water/tech.html>

Collection System Bypass In-Plant Diversion Upset In-Plant Flow Through Spill

1. FACILITY NAME: Leavenworth, City of Kansas Permit # M-MO12-IO01

2. Within 24 hours of discovery, notify the KDHE Central Office (email – cseeds@kdheks.gov), (fax 785.296.0086), (telephone 785.296.5517) or your local KDHE district office. Written notification is required within 5 days of discovery. If the incident is not corrected within 5 days, send a written notification to KDHE indicating the status. This form is to be sent to KDHE when the incident ends.

KDHE Person Contacted: Chris Seeds Date: 3/21/17 Time: 11:10 am

3. Date Incident Discovered: 3/16/2017 Time: 1:42 pm

4. Date Incident Ended: 3/20/2017 Time: 4:00 pm

5. Total estimated gallons bypassed, spilled, or routed through failed equipment for all locations on this form: Unknown (Contained in basement)

6. If rainfall induced event, approximate inches of rainfall n/a

If multiple locations listed below due to rain event, check here

7. Incident Location: (check all that apply)

- | | |
|--|--|
| <input type="checkbox"/> Plant | <input type="checkbox"/> City Collection Line (Line Break / Joint) |
| <input type="checkbox"/> Lift/Pump Station | <input checked="" type="checkbox"/> Private Sewer Line |
| <input type="checkbox"/> Peak Flow Basin | <input checked="" type="checkbox"/> Basement |
| <input type="checkbox"/> Manhole(s) | <input type="checkbox"/> Other (specify below) |

Identify **All** Incident Locations by Name, Street Address or Manhole Number as appropriate.

Teresa Dwyer called stating she had water coming into her basement through the floor drain and that the water in the house has been shut off for two years. Teresa said they have been remodeling the house. The upstream manhole is 0484 and the downstream is 0483.

1028 9th ave manhole 7/21/17

8. Cause of Incident:

- | | |
|---|--|
| <input type="checkbox"/> Intentional Bypass for Repair/Construction | <input type="checkbox"/> Equipment Failure |
| <input type="checkbox"/> Excessive Rainfall, Snow Melt | <input type="checkbox"/> Control System Failure |
| <input type="checkbox"/> Unplanned Construction Related Break | <input type="checkbox"/> Power Related Failure |
| <input type="checkbox"/> City Line Break (Not Construction Related) | <input type="checkbox"/> Operations Related Failure |
| <input type="checkbox"/> City Line Blockage | <input type="checkbox"/> Maintenance Related Failure |
| <input type="checkbox"/> Private Line Break | <input type="checkbox"/> Vandalism |
| <input checked="" type="checkbox"/> Private Line Blockage | <input type="checkbox"/> Other |
| <input type="checkbox"/> Lagoon High Level | |

Additional explanation of reason for Incident: (use additional page if necessary)

Our crew arrived and checked our lines with no problems. We cleaned 442 feet and again there was no problems. Since the water has been shut off it appears that there are two laterals connected.

9. Corrective Action, if any: (use additional page if necessary)

We informed the owner of 1028 9th ave that since the floor drain is backing up it is their responsibility to call a plumber to get this lateral opened up. I was contacted by J.F. Denney plumbing this morning informing me the lateral was open. We will dye test the two houses to confirm they are connected.

Name: Chuck Staples

Date: 3/21/17

Title: Superintendent

Phone: 913-682-1090

**KANSAS DEPARTMENT OF HEALTH AND ENVIRONMENT
WASTEWATER INCIDENT REPORT FORM**

Definitions are available at <http://www.kdheks.gov/water/tech.html>

Collection System Bypass In-Plant Diversion Upset In-Plant Flow Through Spill

1. FACILITY NAME: Leavenworth, City of Kansas Permit # M-MO12-IO01
 2. Within 24 hours of discovery, notify the KDHE Central Office (email – cseeds@kdheks.gov), (fax 785.296.0086), (telephone 785.296.5517) or your local KDHE district office. Written notification is required within 5 days of discovery. If the incident is not corrected within 5 days, send a written notification to KDHE indicating the status. This form is to be sent to KDHE when the incident ends.

KDHE Person Contacted: Chris Seeds Date: 5/16/17 Time: 11:08 am

3. Date Incident Discovered: 3/28/2017 Time: 2:00 pm
 4. Date Incident Ended: 5/16/2017 Time: 11:00 am
 5. Total estimated gallons bypassed, spilled, or routed through failed equipment for all locations on this form: unknown contained in basement
 6. If rainfall induced event, approximate inches of rainfall n/a
 If multiple locations listed below due to rain event, check here

7. Incident Location: (check all that apply)
- | | |
|--|--|
| <input type="checkbox"/> Plant | <input type="checkbox"/> City Collection Line (Line Break / Joint) |
| <input type="checkbox"/> Lift/Pump Station | <input checked="" type="checkbox"/> Private Sewer Line |
| <input type="checkbox"/> Peak Flow Basin | <input checked="" type="checkbox"/> Basement |
| <input type="checkbox"/> Manhole(s) | <input type="checkbox"/> Other (specify below) |

Identify **All** Incident Locations by Name, Street Address or Manhole Number as appropriate.
 We were called concerning a sewer smell at 506 & 504 Delaware Street. The upstream M/H is 0258 and the downstream is 0259.

8. Cause of Incident:
- | | |
|---|--|
| <input type="checkbox"/> Intentional Bypass for Repair/Construction | <input type="checkbox"/> Equipment Failure |
| <input type="checkbox"/> Excessive Rainfall, Snow Melt | <input type="checkbox"/> Control System Failure |
| <input type="checkbox"/> Unplanned Construction Related Break | <input type="checkbox"/> Power Related Failure |
| <input type="checkbox"/> City Line Break (Not Construction Related) | <input type="checkbox"/> Operations Related Failure |
| <input type="checkbox"/> City Line Blockage | <input type="checkbox"/> Maintenance Related Failure |
| <input checked="" type="checkbox"/> Private Line Break | <input type="checkbox"/> Vandalism |
| <input type="checkbox"/> Private Line Blockage | <input type="checkbox"/> Other |
| <input type="checkbox"/> Lagoon High Level | |

Additional explanation of reason for Incident: (use additional page if necessary)
 Upon arrival sewer was noticed leaking into the basement of 506 Delaware and that the 504 Delaware lateral was running into the 506 building before the lateral went to the main. We had no problems with the main line. The owner has been contacted many time but had no responded to the inspector calls.

9. Corrective Action, if any: (use additional page if necessary)
 I sent a e-mail to our inspection branch recommending that he water be turned off at the 506 address. i wan informed the McCann plumbing was going to be working this week at that address. I call Dan from McCann plumbing and he infromed me that last week the lateral was lined and no longer leaking. This was a private line issued from the start.

Name: Chuck Staples Date: 5/16/17
 Title: Superintendent Phone: 913-682-1090

**KANSAS DEPARTMENT OF HEALTH AND ENVIRONMENT
WASTEWATER INCIDENT REPORT FORM**

Definitions are available at <http://www.kdheks.gov/water/tech.html>

Collection System Bypass In-Plant Diversion Upset In-Plant Flow Through Spill

1. FACILITY NAME: Leavenworth, City of Kansas Permit # M-MO12-IO01
 2. Within 24 hours of discovery, notify the KDHE Central Office (email – cseeds@kdheks.gov), (fax 785.296.0086), (telephone 785.296.5517) or your local KDHE district office. Written notification is required within 5 days of discovery. If the incident is not corrected within 5 days, send a written notification to KDHE indicating the status. This form is to be sent to KDHE when the incident ends.

KDHE Person Contacted: Chris Seeds Date: 4/10/17 Time: 8:47 am

3. Date Incident Discovered: 3/29/2017 Time: 12:10 pm
 4. Date Incident Ended: 4/7/2017 Time: 3:00pm
 5. Total estimated gallons bypassed, spilled, or routed through failed equipment for all locations on this form: unknown contained in basement
 6. If rainfall induced event, approximate inches of rainfall n/a
 If multiple locations listed below due to rain event, check here

7. Incident Location: (check all that apply)
- | | |
|--|--|
| <input type="checkbox"/> Plant | <input type="checkbox"/> City Collection Line (Line Break / Joint) |
| <input type="checkbox"/> Lift/Pump Station | <input type="checkbox"/> Private Sewer Line |
| <input type="checkbox"/> Peak Flow Basin | <input checked="" type="checkbox"/> Basement |
| <input type="checkbox"/> Manhole(s) | <input type="checkbox"/> Other (specify below) |

Identify **All** Incident Locations by Name, Street Address or Manhole Number as appropriate.
 Tina called from 604 South 6th street stating that was coming into the house in the basement. the upstream M/H is 0329 and the downstream is 0338.1

8. Cause of Incident:
- | | |
|---|--|
| <input type="checkbox"/> Intentional Bypass for Repair/Construction | <input type="checkbox"/> Equipment Failure |
| <input type="checkbox"/> Excessive Rainfall, Snow Melt | <input type="checkbox"/> Control System Failure |
| <input type="checkbox"/> Unplanned Construction Related Break | <input type="checkbox"/> Power Related Failure |
| <input type="checkbox"/> City Line Break (Not Construction Related) | <input type="checkbox"/> Operations Related Failure |
| <input type="checkbox"/> City Line Blockage | <input type="checkbox"/> Maintenance Related Failure |
| <input type="checkbox"/> Private Line Break | <input type="checkbox"/> Vandalism |
| <input checked="" type="checkbox"/> Private Line Blockage | <input type="checkbox"/> Other |
| <input type="checkbox"/> Lagoon High Level | |

Additional explanation of reason for Incident: (use additional page if necessary)
 After checking our line and rodding 400 feet and found no blockage we talked to the owner.

9. Corrective Action, if any: (use additional page if necessary)
 Our crew informed the owner that our line was flowing and that they needed to call a plumber. I asked the owner to contact us when the lines was open. I was contacted this morning that the line was open Friday afternoon around 3:00 pm

Name: Chuck Staples Date: 41017
 Title: Superintendent Phone: 913-682-1090

When Completed, E-mail to: cseeds@kdheks.gov
 Kansas Department of Health & Environment – Attn: Chris Seeds

**KANSAS DEPARTMENT OF HEALTH AND ENVIRONMENT
WASTEWATER INCIDENT REPORT FORM**

Definitions are available at <http://www.kdheks.gov/water/tech.html>

Collection System Bypass In-Plant Diversion Upset In-Plant Flow Through Spill

1. FACILITY NAME: Leavenworth, City of Kansas Permit # M-MO12-IO01
 2. Within 24 hours of discovery, notify the KDHE Central Office (email – cseeds@kdheks.gov), (fax 785.296.0086), (telephone 785.296.5517) or your local KDHE district office. Written notification is required within 5 days of discovery. If the incident is not corrected within 5 days, send a written notification to KDHE indicating the status. This form is to be sent to KDHE when the incident ends.

KDHE Person Contacted: Chris Seeds Date: 3/30/17 Time: 2:32 pm

3. Date Incident Discovered: 3/29/2017 Time: 6:00 pm
 4. Date Incident Ended: 3/29/2017 Time: 6:45 pm

5. Total estimated gallons bypassed, spilled, or routed through failed equipment for all locations on this form: Unknown contained in basement

6. If rainfall induced event, approximate inches of rainfall n/a
 If multiple locations listed below due to rain event, check here

7. Incident Location: (check all that apply)
- | | |
|--|--|
| <input type="checkbox"/> Plant | <input type="checkbox"/> City Collection Line (Line Break / Joint) |
| <input type="checkbox"/> Lift/Pump Station | <input type="checkbox"/> Private Sewer Line |
| <input type="checkbox"/> Peak Flow Basin | <input type="checkbox"/> Basement |
| <input checked="" type="checkbox"/> Manhole(s) | <input type="checkbox"/> Other (specify below) |

Identify **All** Incident Locations by Name, Street Address or Manhole Number as appropriate.
 Joey Denney a local plumber called stating that a manhole was almost full at 407 Sheridan St. The upstream M/H is 0677 and the downstream is 0664.

8. Cause of Incident:
- | | |
|---|--|
| <input type="checkbox"/> Intentional Bypass for Repair/Construction | <input type="checkbox"/> Equipment Failure |
| <input type="checkbox"/> Excessive Rainfall, Snow Melt | <input type="checkbox"/> Control System Failure |
| <input type="checkbox"/> Unplanned Construction Related Break | <input type="checkbox"/> Power Related Failure |
| <input type="checkbox"/> City Line Break (Not Construction Related) | <input type="checkbox"/> Operations Related Failure |
| <input checked="" type="checkbox"/> City Line Blockage | <input type="checkbox"/> Maintenance Related Failure |
| <input type="checkbox"/> Private Line Break | <input type="checkbox"/> Vandalism |
| <input type="checkbox"/> Private Line Blockage | <input type="checkbox"/> Other |
| <input type="checkbox"/> Lagoon High Level | |

Additional explanation of reason for Incident: (use additional page if necessary)
 Our crew arrived and noticed the upstream M/H was holding water and started to rod from the downstream. At 296 feet we hit a blockage and once we broke through the water started to go down. The water also started to go down in the basement. This is a City line issue.

9. Corrective Action, if any: (use additional page if necessary)
 After the flow of water in the manhole was back to normal we triedd to contact the resident. We could not talk to anyone but was able to talk to the plumber this morning. We will return to this location with our camera crew in an order to see what the blockage was.

Name: Chuck Staples Date: 3/30/17
 Title: Superintendent Phone: 913-682-1090

**KANSAS DEPARTMENT OF HEALTH AND ENVIRONMENT
WASTEWATER INCIDENT REPORT FORM**

Definitions are available at <http://www.kdheks.gov/water/tech.html>

Collection System Bypass In-Plant Diversion Upset In-Plant Flow Through Spill

1. FACILITY NAME: Leavenworth, City of Kansas Permit # M-MO12-IO01
2. Within 24 hours of discovery, notify the KDHE Central Office (email – cseeds@kdheks.gov), (fax 785.296.0086), (telephone 785.296.5517) or your local KDHE district office. Written notification is required within 5 days of discovery. If the incident is not corrected within 5 days, send a written notification to KDHE indicating the status. This form is to be sent to KDHE when the incident ends.

KDHE Person Contacted: Chris Seeds Date: 4/3/17 Time: 12:00 pm

3. Date Incident Discovered: 3/31/2017 Time: 2:30 pm

4. Date Incident Ended: 4/1/2017 Time: 1:00 pm

5. Total estimated gallons bypassed, spilled, or routed through failed equipment for all locations on this form: 5 gallons

6. If rainfall induced event, approximate inches of rainfall n/a

If multiple locations listed below due to rain event, check here

7. Incident Location: (check all that apply)

- | | |
|--|--|
| <input type="checkbox"/> Plant | <input type="checkbox"/> City Collection Line (Line Break / Joint) |
| <input type="checkbox"/> Lift/Pump Station | <input checked="" type="checkbox"/> Private Sewer Line |
| <input type="checkbox"/> Peak Flow Basin | <input type="checkbox"/> Basement |
| <input type="checkbox"/> Manhole(s) | <input type="checkbox"/> Other (specify below) |

Identify **All** Incident Locations by Name, Street Address or Manhole Number as appropriate.

While inspection manholes for another project we noticed water flowing across a concrete pad at 528 Pawnee St. The upstream M/H is 0009.2 and the downstream is 0009. I contacted the plumber for the owner and he said he would respond. This is a private line issue.

8. Cause of Incident:

- | | |
|---|--|
| <input type="checkbox"/> Intentional Bypass for Repair/Construction | <input type="checkbox"/> Equipment Failure |
| <input type="checkbox"/> Excessive Rainfall, Snow Melt | <input type="checkbox"/> Control System Failure |
| <input type="checkbox"/> Unplanned Construction Related Break | <input type="checkbox"/> Power Related Failure |
| <input type="checkbox"/> City Line Break (Not Construction Related) | <input type="checkbox"/> Operations Related Failure |
| <input type="checkbox"/> City Line Blockage | <input type="checkbox"/> Maintenance Related Failure |
| <input type="checkbox"/> Private Line Break | <input type="checkbox"/> Vandalism |
| <input checked="" type="checkbox"/> Private Line Blockage | <input type="checkbox"/> Other |
| <input type="checkbox"/> Lagoon High Level | |

Additional explanation of reason for Incident: (use additional page if necessary)

Our crew responded by placing containment socks and spread lime on the ground.

9. Corrective Action, if any: (use additional page if necessary)

The plumber contacted me this morning and said he got the line open around 1:00 pm on April 1.

Name: Chuck Staples Date: 4/03/17

Title: Superintendent Phone: 913-682-1090

When Completed, E-mail to: cseeds@kdheks.gov

Kansas Department of Health & Environment – Attn: Chris Seeds

Or Mail to: 1000 SW Jackson St., Suite 420, Topeka, KS 66612-1367



SANITARY SEWER OVRFLOWS

APRIL 2017



**KANSAS DEPARTMENT OF HEALTH AND ENVIRONMENT
WASTEWATER INCIDENT REPORT FORM**

Definitions are available at <http://www.kdheks.gov/water/tech.html>

Collection System Bypass In-Plant Diversion In-Plant Upset In-Plant Flow Through Spill

1. FACILITY NAME: Leavenworth, City of Kansas Permit # M-MO12-IO01
 2. Within 24 hours of discovery, notify the KDHE Central Office (email – cseeds@kdheks.gov), (fax 785.296.0086), (telephone 785.296.5517) or your local KDHE district office. Written notification is required within 5 days of discovery. If the incident is not corrected within 5 days, send a written notification to KDHE indicating the status. This form is to be sent to KDHE when the incident ends.

KDHE Person Contacted: Chris Seeds Date: 4/3/17 Time: 12:28 pm

3. Date Incident Discovered: 4/3/2017 Time: 8:32 am
 4. Date Incident Ended: 4/3/2017 Time: 9:30 am
 5. Total estimated gallons bypassed, spilled, or routed through failed equipment for all locations on this form: 4500 gallons
 6. If rainfall induced event, approximate inches of rainfall Yes. 1 in
 If multiple locations listed below due to rain event, check here

7. Incident Location: (check all that apply)
- | | |
|--|--|
| <input type="checkbox"/> Plant | <input type="checkbox"/> City Collection Line (Line Break / Joint) |
| <input type="checkbox"/> Lift/Pump Station | <input type="checkbox"/> Private Sewer Line |
| <input type="checkbox"/> Peak Flow Basin | <input type="checkbox"/> Basement |
| <input checked="" type="checkbox"/> Manhole(s) | <input type="checkbox"/> Other (specify below) |

Identify **All** Incident Locations by Name, Street Address or Manhole Number as appropriate.
 Joy Anaya called stating that the manhole next to the creek at 1414 Ottawas was overflowing. The upstream M/H is 0699.1 and the downstream M/H is 0698.1

8. Cause of Incident:
- | | |
|---|--|
| <input type="checkbox"/> Intentional Bypass for Repair/Construction | <input type="checkbox"/> Equipment Failure |
| <input type="checkbox"/> Excessive Rainfall, Snow Melt | <input type="checkbox"/> Control System Failure |
| <input type="checkbox"/> Unplanned Construction Related Break | <input type="checkbox"/> Power Related Failure |
| <input type="checkbox"/> City Line Break (Not Construction Related) | <input type="checkbox"/> Operations Related Failure |
| <input checked="" type="checkbox"/> City Line Blockage | <input type="checkbox"/> Maintenance Related Failure |
| <input type="checkbox"/> Private Line Break | <input type="checkbox"/> Vandalism |
| <input type="checkbox"/> Private Line Blockage | <input type="checkbox"/> Other |
| <input type="checkbox"/> Lagoon High Level | |

Additional explanation of reason for Incident: (use additional page if necessary)
 We rodded or line an hit no blockage the manhole was holding water. The overflowing manhole stopped overflowing at 9:30 am. The city had received over one inche of rain this morning.

9. Corrective Action, if any: (use additional page if necessary)
 After we rodded our line the water started to go down. We placed contaminated Creek sign out and will take upstream and downstream E-coli samples before removing this signs. We will also place information on the City of Leavenworths web site to let residents know of this overflow.

Name: Chuck Staples Date: 4/03/17
 Title: Superintendent Phone: 913-682-1090

When Completed, E-mail to: cseeds@kdheks.gov

**KANSAS DEPARTMENT OF HEALTH AND ENVIRONMENT
WASTEWATER INCIDENT REPORT FORM**

Definitions are available at <http://www.kdheks.gov/water/tech.html>

Collection System Bypass In-Plant Diversion Upset In-Plant Flow Through Spill

1. FACILITY NAME: Leavenworth, City of Kansas Permit # M-MO12-IO01
2. Within 24 hours of discovery, notify the KDHE Central Office (email – cseeds@kdheks.gov), (fax 785.296.0086), (telephone 785.296.5517) or your local KDHE district office. Written notification is required within 5 days of discovery. If the incident is not corrected within 5 days, send a written notification to KDHE indicating the status. This form is to be sent to KDHE when the incident ends.

KDHE Person Contacted: Chris Seeds Date: 4/7/17 Time: 3:27 pm

3. Date Incident Discovered: 4/3/2017 Time: 12:15 pm

4. Date Incident Ended: 4/7/2017 Time: 3:00 pm

5. Total estimated gallons bypassed, spilled, or routed through failed equipment for all locations on this form: 12 gallons(contained in basement and doorway)

6. If rainfall induced event, approximate inches of rainfall n/a

If multiple locations listed below due to rain event, check here

7. Incident Location: (check all that apply)

- | | |
|--|--|
| <input type="checkbox"/> Plant | <input type="checkbox"/> City Collection Line (Line Break / Joint) |
| <input type="checkbox"/> Lift/Pump Station | <input checked="" type="checkbox"/> Private Sewer Line |
| <input type="checkbox"/> Peak Flow Basin | <input type="checkbox"/> Basement |
| <input type="checkbox"/> Manhole(s) | <input type="checkbox"/> Other (specify below) |

Identify **All** Incident Locations by Name, Street Address or Manhole Number as appropriate.

Mr. Tuttle called stating that water was backing up at 1030 Randolph Street. The upstream M/H is 0423 and the downstream has not been updated as it is new.

8. Cause of Incident:

- | | |
|---|--|
| <input type="checkbox"/> Intentional Bypass for Repair/Construction | <input type="checkbox"/> Equipment Failure |
| <input type="checkbox"/> Excessive Rainfall, Snow Melt | <input type="checkbox"/> Control System Failure |
| <input type="checkbox"/> Unplanned Construction Related Break | <input type="checkbox"/> Power Related Failure |
| <input type="checkbox"/> City Line Break (Not Construction Related) | <input type="checkbox"/> Operations Related Failure |
| <input type="checkbox"/> City Line Blockage | <input type="checkbox"/> Maintenance Related Failure |
| <input type="checkbox"/> Private Line Break | <input type="checkbox"/> Vandalism |
| <input checked="" type="checkbox"/> Private Line Blockage | <input type="checkbox"/> Other |
| <input type="checkbox"/> Lagoon High Level | |

Additional explanation of reason for Incident: (use additional page if necessary)

Upon arrival we checked our lines and found no manhole backed up and we rodded 350 with no problems.

9. Corrective Action, if any: (use additional page if necessary)

We informed Mr. Tuttle that he needed to call a plumber and we placed containment socks around the basement door. We asked Mr. Tuttle to contact us when his line was open

Name: Chuck Staples Date: 4/07/17

Title: Superintendent Phone: 913-682-1090

When Completed, E-mail to: cseeds@kdheks.gov

Kansas Department of Health & Environment – Attn: Chris Seeds

**KANSAS DEPARTMENT OF HEALTH AND ENVIRONMENT
WASTEWATER INCIDENT REPORT FORM**

Definitions are available at <http://www.kdheks.gov/water/tech.html>

Collection System Bypass In-Plant Diversion Upset In-Plant Flow Through Spill

1. FACILITY NAME: Leavenworth, City of Kansas Permit # M-MO12-IO01
2. Within 24 hours of discovery, notify the KDHE Central Office (email – cseeds@kdheks.gov), (fax 785.296.0086), (telephone 785.296.5517) or your local KDHE district office. Written notification is required within 5 days of discovery. If the incident is not corrected within 5 days, send a written notification to KDHE indicating the status. This form is to be sent to KDHE when the incident ends.

KDHE Person Contacted: Chris Seeds Date: 4/10/17 Time: 8:22 am

3. Date Incident Discovered: 4/7/2017 Time: 12:05 pm
4. Date Incident Ended: 4/7/2017 Time: 6:00 pm
5. Total estimated gallons bypassed, spilled, or routed through failed equipment for all locations on this form: 1 gallon contained in basement
6. If rainfall induced event, approximate inches of rainfall n/a
 If multiple locations listed below due to rain event, check here

7. Incident Location: (check all that apply)
- | | |
|--|--|
| <input type="checkbox"/> Plant | <input type="checkbox"/> City Collection Line (Line Break / Joint) |
| <input type="checkbox"/> Lift/Pump Station | <input type="checkbox"/> Private Sewer Line |
| <input type="checkbox"/> Peak Flow Basin | <input checked="" type="checkbox"/> Basement |
| <input type="checkbox"/> Manhole(s) | <input type="checkbox"/> Other (specify below) |

Identify **All** Incident Locations by Name, Street Address or Manhole Number as appropriate.
Mike Baskas called stating that his basement was backing up with water at 1129 Metropolitan. The upstream M/H is 0027.1 and the downstream M/H is 0027.

8. Cause of Incident:
- | | |
|---|--|
| <input type="checkbox"/> Intentional Bypass for Repair/Construction | <input type="checkbox"/> Equipment Failure |
| <input type="checkbox"/> Excessive Rainfall, Snow Melt | <input type="checkbox"/> Control System Failure |
| <input type="checkbox"/> Unplanned Construction Related Break | <input type="checkbox"/> Power Related Failure |
| <input type="checkbox"/> City Line Break (Not Construction Related) | <input type="checkbox"/> Operations Related Failure |
| <input type="checkbox"/> City Line Blockage | <input type="checkbox"/> Maintenance Related Failure |
| <input type="checkbox"/> Private Line Break | <input type="checkbox"/> Vandalism |
| <input checked="" type="checkbox"/> Private Line Blockage | <input type="checkbox"/> Other |
| <input type="checkbox"/> Lagoon High Level | |

Additional explanation of reason for Incident: (use additional page if necessary)
Upon arrival the downstream M/H was flowing good and since his lateral comes into the manhole we informed Mr. Baskas that he needed to call a plumber.

9. Corrective Action, if any: (use additional page if necessary)
Mr. Bakas said he would call a plumber and then call us as to when his line was opened. He called stating that the line was opened around 6 pm Friday evening.

Name: Chuck Staples Date: 4/10/17
Title: Superintendent Phone: 913-682-1090

When Completed, E-mail to: cseeds@kdheks.gov
Kansas Department of Health & Environment – Attn: Chris Seeds

**KANSAS DEPARTMENT OF HEALTH AND ENVIRONMENT
WASTEWATER INCIDENT REPORT FORM**

Definitions are available at <http://www.kdheks.gov/water/tech.html>

Collection System Bypass In-Plant Diversion Upset In-Plant Flow Through Spill

1. FACILITY NAME: Leavenworth, City of Kansas Permit # M-MO12-IO01
2. Within 24 hours of discovery, notify the KDHE Central Office (email – cseeds@kdheks.gov), (fax 785.296.0086), (telephone 785.296.5517) or your local KDHE district office. Written notification is required within 5 days of discovery. If the incident is not corrected within 5 days, send a written notification to KDHE indicating the status. This form is to be sent to KDHE when the incident ends.

KDHE Person Contacted: Chris Seeds Date: 4/17/17 Time: 9:04 am

3. Date Incident Discovered: 4/13/2017 Time: 5:15 pm
4. Date Incident Ended: 4/15/2017 Time: 9:00 am

5. Total estimated gallons bypassed, spilled, or routed through failed equipment for all locations on this form: unknown(contained in yard)

6. If rainfall induced event, approximate inches of rainfall n/a

If multiple locations listed below due to rain event, check here

7. Incident Location: (check all that apply)

- | | |
|--|--|
| <input type="checkbox"/> Plant | <input type="checkbox"/> City Collection Line (Line Break / Joint) |
| <input type="checkbox"/> Lift/Pump Station | <input checked="" type="checkbox"/> Private Sewer Line |
| <input type="checkbox"/> Peak Flow Basin | <input type="checkbox"/> Basement |
| <input type="checkbox"/> Manhole(s) | <input type="checkbox"/> Other (specify below) |

Identify **All** Incident Locations by Name, Street Address or Manhole Number as appropriate.

We were contacted by our plumbing inspector stating that water was running on the ground at 1322 or 1326 Olive Street. The upstream M/H is 1240 and the downstream M/H is 1239.

8. Cause of Incident:

- | | |
|---|--|
| <input type="checkbox"/> Intentional Bypass for Repair/Construction | <input type="checkbox"/> Equipment Failure |
| <input type="checkbox"/> Excessive Rainfall, Snow Melt | <input type="checkbox"/> Control System Failure |
| <input type="checkbox"/> Unplanned Construction Related Break | <input type="checkbox"/> Power Related Failure |
| <input type="checkbox"/> City Line Break (Not Construction Related) | <input type="checkbox"/> Operations Related Failure |
| <input type="checkbox"/> City Line Blockage | <input type="checkbox"/> Maintenance Related Failure |
| <input type="checkbox"/> Private Line Break | <input type="checkbox"/> Vandalism |
| <input checked="" type="checkbox"/> Private Line Blockage | <input type="checkbox"/> Other |
| <input type="checkbox"/> Lagoon High Level | |

Additional explanation of reason for Incident: (use additional page if necessary)

Upon arrival there was water standing in the alley that seemed to be potable water. We checked our sewer lines and found no problems.

9. Corrective Action, if any: (use additional page if necessary)

We contacted the plumbing inspector stating that the City lines were good and we did not see any overflow. The next morning we were contacted stating the the owner at 1322 Olive Street had called a plumber. This was a private line issue and was corrected by 3/15/17 at 9:00 am.

Name: Chuck Staples

Date: 4/17/17

Title: Superintendent

Phone: 913-682-1090

When Completed, E-mail to: cseeds@kdheks.gov

**KANSAS DEPARTMENT OF HEALTH AND ENVIRONMENT
WASTEWATER BYPASS REPORT FORM**

1. FACILITY NAME: Fort Leavenworth Kansas Permit # M-MO12-IO 01

2. Within 24 Hours of Discovery, Notify the KDHE Central Office (email – cseeds@kdhe.state.ks.us), (fax 785.296.0086), (telephone 785.296.5517) or your KDHE local district office. Written notification required within 5 days of discovery.

KDHE Person Contacted: Chris Seeds Date: 7 APR 17 Time: 1500 hrs

3. Date Bypass Discovered: 7 APR 17 Time: 1400 Hrs

4. Date Bypass Ended: 7 APR 17 Time: 1459 hrs

5. Total Estimated Gallons Bypassed for All Locations on this Form: 250

6. If rainfall event, approximate inches of rainfall N/A

If multiple bypass locations listed below due to rain event, check here _____

7. Bypass Location: (check all that apply)

<input type="checkbox"/> Plant	<input type="checkbox"/> City Collection Line
<input type="checkbox"/> Lift/Pump Station	<input type="checkbox"/> Private Sewer Line
<input type="checkbox"/> Peak Flow Basin	<input type="checkbox"/> Other (specify below)
<input checked="" type="checkbox"/> Manhole(s) (list manhole #'s below)	

8. Cause of Bypass: (definitions available at <http://www.kdheks.gov/water/tech.html>)

<input type="checkbox"/> Intentional Bypass for Repair/Construction	<input type="checkbox"/> Equipment Failure
<input type="checkbox"/> Excessive Rainfall, Snow Melt	<input type="checkbox"/> Control System Failure
<input type="checkbox"/> Unplanned Construction Related Break	<input type="checkbox"/> Power Related Failure
<input type="checkbox"/> City Line Break (Not Construction Related)	<input type="checkbox"/> Operations Related Failure
<input type="checkbox"/> City Line Blockage	<input type="checkbox"/> Maintenance Related Failure
<input type="checkbox"/> Private Line Break	<input type="checkbox"/> Vandalism
<input type="checkbox"/> Private Line Blockage	<input type="checkbox"/> Spill
<input type="checkbox"/> Lagoon High Level	<input checked="" type="checkbox"/> Other

Additional explanation of reason for bypass: (use additional page if necessary)

- Manhole backup 7 APR 17 by the College lower lake (Manmade lake).
- The crews responded within 15 minutes and jetted the line to clear the blockage (disposable cleaning rags and some grease).
- Estimated 150-250 gals on the ground and possibly 100 gals leached it into the lake.

9. Corrective Action, if any: (use additional page if necessary)

- Crew completed site restoration- Vacuumed debris around manhole and spreading lime around area ... ensuring none entered the lake.

Name: Edwin F Winton Date: 7 APR 17

Title: GM American Water Works Ft Leavenworth

When Completed, Mail to: Kansas Department of Health and Environment
Attn: Chris Seeds
1000 SW Jackson St., Suite 420
Topeka, KS 66612-1367

**KANSAS DEPARTMENT OF HEALTH AND ENVIRONMENT
WASTEWATER INCIDENT REPORT FORM**

Definitions are available at <http://www.kdheks.gov/water/tech.html>

Collection System Bypass In-Plant Diversion Upset In-Plant Flow Through Spill

1. FACILITY NAME: Leavenworth, City of Kansas Permit # M-MO12-IO01
 2. Within 24 hours of discovery, notify the KDHE Central Office (email – cseeds@kdheks.gov), (fax 785.296.0086), (telephone 785.296.5517) or your local KDHE district office. Written notification is required within 5 days of discovery. If the incident is not corrected within 5 days, send a written notification to KDHE indicating the status. This form is to be sent to KDHE when the incident ends.

KDHE Person Contacted: Chris Seeds Date: 4/19/17 Time: 1:03 pm

3. Date Incident Discovered: 4/11/2017 Time: 8:00 am
 4. Date Incident Ended: 4/19/2017 Time: 11:00 am
 5. Total estimated gallons bypassed, spilled, or routed through failed equipment for all locations on this form: 10 gallons
 6. If rainfall induced event, approximate inches of rainfall n/a
 If multiple locations listed below due to rain event, check here

7. Incident Location: (check all that apply)
- | | |
|--|--|
| <input type="checkbox"/> Plant | <input type="checkbox"/> City Collection Line (Line Break / Joint) |
| <input type="checkbox"/> Lift/Pump Station | <input checked="" type="checkbox"/> Private Sewer Line |
| <input type="checkbox"/> Peak Flow Basin | <input type="checkbox"/> Basement |
| <input type="checkbox"/> Manhole(s) | <input type="checkbox"/> Other (specify below) |

Identify **All** Incident Locations by Name, Street Address or Manhole Number as appropriate. Assitand Superintendent was driving past 1623 4th Ave and noticed water runn down the curb. We talked to the owner and they had already contacted a plumber. The upstream MH is 0745 and the downstream MH is 0746.

8. Cause of Incident:
- | | |
|---|--|
| <input type="checkbox"/> Intentional Bypass for Repair/Construction | <input type="checkbox"/> Equipment Failure |
| <input type="checkbox"/> Excessive Rainfall, Snow Melt | <input type="checkbox"/> Control System Failure |
| <input type="checkbox"/> Unplanned Construction Related Break | <input type="checkbox"/> Power Related Failure |
| <input type="checkbox"/> City Line Break (Not Construction Related) | <input type="checkbox"/> Operations Related Failure |
| <input type="checkbox"/> City Line Blockage | <input type="checkbox"/> Maintenance Related Failure |
| <input checked="" type="checkbox"/> Private Line Break | <input type="checkbox"/> Vandalism |
| <input checked="" type="checkbox"/> Private Line Blockage | <input type="checkbox"/> Other |
| <input type="checkbox"/> Lagoon High Level | |

Additional explanation of reason for Incident: (use additional page if necessary)

This is the second overflow this year at this location and the owner is having the lateral running under the street. They had the line bored and replaced. This is a private line issue.

9. Corrective Action, if any: (use additional page if necessary)
 Our crew cleaned our line and then placed containment socks on the street corner. The owner was asked to limit the water usage. I was contacted this morning that the line had been repaired and was flowing normal.

Name: Chuck Staples Date: 4/19/17
 Title: Superintendent Phone: 913-682-1090

**KANSAS DEPARTMENT OF HEALTH AND ENVIRONMENT
WASTEWATER INCIDENT REPORT FORM**

Definitions are available at <http://www.kdheks.gov/water/tech.html>

Collection System Bypass In-Plant Diversion Upset In-Plant Flow Through Spill

1. FACILITY NAME: Leavenworth, City of Kansas Permit # M-MO12-IO01
 2. Within 24 hours of discovery, notify the KDHE Central Office (email – cseeds@kdheks.gov), (fax 785.296.0086), (telephone 785.296.5517) or your local KDHE district office. Written notification is required within 5 days of discovery. If the incident is not corrected within 5 days, send a written notification to KDHE indicating the status. This form is to be sent to KDHE when the incident ends.

KDHE Person Contacted: Chris Seeds Date: 4/22/17 Time: 10:32 am

3. Date Incident Discovered: 4/21/2017 Time: 6:23 pm
 4. Date Incident Ended: 4/21/2017 Time: 7:30 pm
 5. Total estimated gallons bypassed, spilled, or routed through failed equipment for all locations on this form: 2700 gallons
 6. If rainfall induced event, approximate inches of rainfall n/a
 If multiple locations listed below due to rain event, check here

7. Incident Location: (check all that apply)
- | | |
|--|--|
| <input type="checkbox"/> Plant | <input type="checkbox"/> City Collection Line (Line Break / Joint) |
| <input type="checkbox"/> Lift/Pump Station | <input type="checkbox"/> Private Sewer Line |
| <input type="checkbox"/> Peak Flow Basin | <input checked="" type="checkbox"/> Basement |
| <input checked="" type="checkbox"/> Manhole(s) | <input type="checkbox"/> Other (specify below) |

Identify **All** Incident Locations by Name, Street Address or Manhole Number as appropriate.
 Dennis Gagne called stating the creek smelled like sewer at 1313 4th Ave. The upstream M/H is 0536 and the downstream M/H is 0553.

8. Cause of Incident:
- | | |
|---|--|
| <input type="checkbox"/> Intentional Bypass for Repair/Construction | <input type="checkbox"/> Equipment Failure |
| <input type="checkbox"/> Excessive Rainfall, Snow Melt | <input type="checkbox"/> Control System Failure |
| <input type="checkbox"/> Unplanned Construction Related Break | <input type="checkbox"/> Power Related Failure |
| <input type="checkbox"/> City Line Break (Not Construction Related) | <input type="checkbox"/> Operations Related Failure |
| <input checked="" type="checkbox"/> City Line Blockage | <input type="checkbox"/> Maintenance Related Failure |
| <input type="checkbox"/> Private Line Break | <input type="checkbox"/> Vandalism |
| <input type="checkbox"/> Private Line Blockage | <input type="checkbox"/> Other |
| <input type="checkbox"/> Lagoon High Level | |

Additional explanation of reason for Incident: (use additional page if necessary)
 Upon arrival we found a manhole overflowing around the segment of the top cone joint and water running into the creek nearby. We will make a transparency report for the Cities web site.

9. Corrective Action, if any: (use additional page if necessary)
 We rodded the line for 165 ft and hit a root ball and the water receded at once. We was able to get out of the line. The root ball was in the invert of the manhole which caused the overflow. We placed 5 contaminated Creek signs located for 4th Ave to 3rd Ave and also on Poplar Street. We thanked Mr. Gagne for calling.

Name: Chuck Staples Date: 4/22/17
 Title: Superintendent Phone: 913-682-1090

**KANSAS DEPARTMENT OF HEALTH AND ENVIRONMENT
WASTEWATER INCIDENT REPORT FORM**

Definitions are available at <http://www.kdheks.gov/water/tech.html>

Collection System Bypass In-Plant Diversion Upset In-Plant Flow Through Spill

1. FACILITY NAME: Leavenworth, City of Kansas Permit # M-MO12-IO01
 2. Within 24 hours of discovery, notify the KDHE Central Office (email – cseeds@kdheks.gov), (fax 785.296.0086), (telephone 785.296.5517) or your local KDHE district office. Written notification is required within 5 days of discovery. If the incident is not corrected within 5 days, send a written notification to KDHE indicating the status. This form is to be sent to KDHE when the incident ends.

KDHE Person Contacted: Chris Seeds Date: 4/24/17 Time: 10:10 am

3. Date Incident Discovered: 4/22/2017 Time: 7:35 pm
 4. Date Incident Ended: 4/22/2017 Time: 8:45 pm
 5. Total estimated gallons bypassed, spilled, or routed through failed equipment for all locations on this form: one gallon
 6. If rainfall induced event, approximate inches of rainfall n/a
 If multiple locations listed below due to rain event, check here

7. Incident Location: (check all that apply)
- | | |
|--|--|
| <input type="checkbox"/> Plant | <input type="checkbox"/> City Collection Line (Line Break / Joint) |
| <input type="checkbox"/> Lift/Pump Station | <input type="checkbox"/> Private Sewer Line |
| <input type="checkbox"/> Peak Flow Basin | <input checked="" type="checkbox"/> Basement |
| <input type="checkbox"/> Manhole(s) | <input type="checkbox"/> Other (specify below) |

Identify **All** Incident Locations by Name, Street Address or Manhole Number as appropriate.
Robert Dickerson called stating his washing machine was backing up at 810 Pottawatomie St. The upstream M/H is 01683.2 and the downstream M/H is 0169.

8. Cause of Incident:
- | | |
|---|--|
| <input type="checkbox"/> Intentional Bypass for Repair/Construction | <input type="checkbox"/> Equipment Failure |
| <input type="checkbox"/> Excessive Rainfall, Snow Melt | <input type="checkbox"/> Control System Failure |
| <input type="checkbox"/> Unplanned Construction Related Break | <input type="checkbox"/> Power Related Failure |
| <input type="checkbox"/> City Line Break (Not Construction Related) | <input type="checkbox"/> Operations Related Failure |
| <input type="checkbox"/> City Line Blockage | <input type="checkbox"/> Maintenance Related Failure |
| <input type="checkbox"/> Private Line Break | <input type="checkbox"/> Vandalism |
| <input checked="" type="checkbox"/> Private Line Blockage | <input type="checkbox"/> Other |
| <input type="checkbox"/> Lagoon High Level | |

Additional explanation of reason for Incident: (use additional page if necessary)
We checked our line and had good flow but we rodded 200 feet with no problem. Mr. Dicerson stated that once the initial backup happened the drain started to drain properly. This is a private line issue

9. Corrective Action, if any: (use additional page if necessary)
We rodded our line and informed the owner that if the line continues to back up he needed to call a plumber.

Name: Chuck Staples Date: 4/24/17
 Title: Superintendent Phone: 913-682-1090

When Completed, E-mail to: cseeds@kdheks.gov
 Kansas Department of Health & Environment – Attn: Chris Seeds

KANSAS DEPARTMENT OF HEALTH AND ENVIRONMENT
WASTEWATER INCIDENT REPORT FORM

Federal
Prison

Definitions are available at <http://www.kdheks.gov/water/tech.html>

Collection System Bypass In-Plant Diversion Upset In-Plant Flow Through Spill

1. FACILITY NAME: USP LEAVENWORTH Kansas Permit # FMO12PO06
2. Within 24 hours of discovery, notify the KDHE Central Office (email – cseeds@kdheks.gov), (fax 785.296.0086), (telephone 785.296.5517) or your local KDHE district office. Written notification is required within 5 days of discovery. If the incident is not corrected within 5 days, send a written notification to KDHE indicating the status. This form is to be sent to KDHE when the incident ends.

IF THE INCIDENT IS AFTER HOURS AND REPRESENTS A SIGNIFICANT PUBLIC HEALTH THREAT CALL 785.296.1679 IMMEDIATELY

KDHE Person Contacted: HELEN HOLME Date: 4/24/17 Time: 1:30 PM

3. Date Incident Discovered: 4/22/2017 Time: 6:30 PM
4. Date Incident Ended: 4/22/2017 Time: 6:45 PM
5. Total estimated gallons bypassed, spilled, or routed through failed equipment for all locations on this form: 50 GALLONS
6. If rainfall induced event, approximate inches of rainfall _____
If multiple locations listed below due to rain event, check here

7. Incident Location: (check all that apply)

- | | |
|---|--|
| <input type="checkbox"/> Plant | <input type="checkbox"/> City Collection Line (Line Break / Joint) |
| <input checked="" type="checkbox"/> Lift/Pump Station | <input type="checkbox"/> Private Sewer Line |
| <input type="checkbox"/> Peak Flow Basin | <input type="checkbox"/> Basement |
| <input type="checkbox"/> Manhole(s) | <input type="checkbox"/> Other (specify below) |

Identify **All** Incident Locations by Name, Street Address or Manhole Number as appropriate.

LIFT STATION LOCATED ON 1300 METROPOLITAN AVE

8. Cause of Incident:

- | | |
|---|---|
| <input type="checkbox"/> Intentional Bypass for Repair/Construction | <input checked="" type="checkbox"/> Equipment Failure |
| <input type="checkbox"/> Excessive Rainfall, Snow Melt | <input type="checkbox"/> Control System Failure |
| <input type="checkbox"/> Unplanned Construction Related Break | <input type="checkbox"/> Power Related Failure |
| <input type="checkbox"/> City Line Break (Not Construction Related) | <input type="checkbox"/> Operations Related Failure |
| <input type="checkbox"/> City Line Blockage | <input type="checkbox"/> Maintenance Related Failure |
| <input type="checkbox"/> Private Line Break | <input type="checkbox"/> Vandalism |
| <input type="checkbox"/> Private Line Blockage | <input type="checkbox"/> Other |
| <input type="checkbox"/> Lagoon High Level | |

Additional explanation of reason for incident: (use additional page if necessary)

WHEN THE #1 PUMP WENT DOWN THE BACK UP DID NOT TURN ON.

9. Corrective Action, if any: (use additional page if necessary)

WE ARE ORDERING NEW PUMPS AND UPDATING BREAKER BOXES

Name: BILLYE E CORDELL Date: 5/3/2017

Title: SAFETY MANAGER Phone: 913-578-1387

When Completed, E-mail to: cseeds@kdheks.gov

Kansas Department of Health & Environment – Attn: Chris Seeds
Or Mail to: 1000 SW Jackson St., Suite 420, Topeka, KS 66612-1367
Fax 785.296.0086

**KANSAS DEPARTMENT OF HEALTH AND ENVIRONMENT
WASTEWATER INCIDENT REPORT FORM**

Definitions are available at <http://www.kdheks.gov/water/tech.html>

Collection System Bypass In-Plant Diversion Upset In-Plant Flow Through Spill

1. FACILITY NAME: Leavenworth, City of Kansas Permit # M-MO12-IO01
2. Within 24 hours of discovery, notify the KDHE Central Office (email – cseeds@kdheks.gov), (fax 785.296.0086), (telephone 785.296.5517) or your local KDHE district office. Written notification is required within 5 days of discovery. If the incident is not corrected within 5 days, send a written notification to KDHE indicating the status. This form is to be sent to KDHE when the incident ends.

KDHE Person Contacted: Chris Seeds Date: 5/1/17 Time: 8:20 am

3. Date Incident Discovered: 4/28/2017 Time: 8:45 am

4. Date Incident Ended: 4/28/2017 Time: 3:00 pm

5. Total estimated gallons bypassed, spilled, or routed through failed equipment for all locations on this form: unknown (contained in basement)

6. If rainfall induced event, approximate inches of rainfall n/a

If multiple locations listed below due to rain event, check here

7. Incident Location: (check all that apply)

- | | |
|--|--|
| <input type="checkbox"/> Plant | <input type="checkbox"/> City Collection Line (Line Break / Joint) |
| <input type="checkbox"/> Lift/Pump Station | <input checked="" type="checkbox"/> Private Sewer Line |
| <input type="checkbox"/> Peak Flow Basin | <input type="checkbox"/> Basement |
| <input type="checkbox"/> Manhole(s) | <input type="checkbox"/> Other (specify below) |

Identify **All** Incident Locations by Name, Street Address or Manhole Number as appropriate.

Mrs. Bohne called stating that her drain was backing up in the basement at 2900 Meadow rd. The upstream M/H is 1636 and 1348 and the downstream M/H is 1347.

8. Cause of Incident:

- | | |
|---|--|
| <input type="checkbox"/> Intentional Bypass for Repair/Construction | <input type="checkbox"/> Equipment Failure |
| <input type="checkbox"/> Excessive Rainfall, Snow Melt | <input type="checkbox"/> Control System Failure |
| <input type="checkbox"/> Unplanned Construction Related Break | <input type="checkbox"/> Power Related Failure |
| <input type="checkbox"/> City Line Break (Not Construction Related) | <input type="checkbox"/> Operations Related Failure |
| <input type="checkbox"/> City Line Blockage | <input type="checkbox"/> Maintenance Related Failure |
| <input checked="" type="checkbox"/> Private Line Break | <input type="checkbox"/> Vandalism |
| <input type="checkbox"/> Private Line Blockage | <input type="checkbox"/> Other |
| <input type="checkbox"/> Lagoon High Level | |

Additional explanation of reason for Incident: (use additional page if necessary)

Upon arrival we checked the Cities main and had good flow. We rodded 505 feet and had no blockage.

9. Corrective Action, if any: (use additional page if necessary)

Once our crew checked our lines they informed the owner that they needed to call a plumber. We took pictures but the backup had already been cleaned up. I contacted the owner this morning and the plumber had the line opened at 3:00 pm on 4/28/17

Name: Chuck Staples

Date: 5/01/17

Title: Superintendent

Phone: 913-682-1090



When Completed, E-mail to: cseeds@kdheks.gov

Kansas Department of Health & Environment – Attn: Chris Seeds



SANITARY SEWER OVRFLOWS

MAY 2017



**KANSAS DEPARTMENT OF HEALTH AND ENVIRONMENT
WASTEWATER INCIDENT REPORT FORM**

Definitions are available at <http://www.kdheks.gov/water/tech.html>

Collection System Bypass In-Plant Diversion Upset In-Plant Flow Through Spill

1. FACILITY NAME: Leavenworth, City of Kansas Permit # M-MO12-IO01
 2. Within 24 hours of discovery, notify the KDHE Central Office (email – cseeds@kdheks.gov), (fax 785.296.0086), (telephone 785.296.5517) or your local KDHE district office. Written notification is required within 5 days of discovery. If the incident is not corrected within 5 days, send a written notification to KDHE indicating the status. This form is to be sent to KDHE when the incident ends.

KDHE Person Contacted: Chris Seeds Date: 5/25/17 Time: 11:49 am

3. Date Incident Discovered: 5/16/2017 Time: 9:00 am
 4. Date Incident Ended: 5/25/2017 Time: 10:00 am
 5. Total estimated gallons bypassed, spilled, or routed through failed equipment for all locations on this form: unknown
 6. If rainfall induced event, approximate inches of rainfall n/a
 If multiple locations listed below due to rain event, check here

7. Incident Location: (check all that apply)
- | | |
|--|--|
| <input type="checkbox"/> Plant | <input type="checkbox"/> City Collection Line (Line Break / Joint) |
| <input type="checkbox"/> Lift/Pump Station | <input type="checkbox"/> Private Sewer Line |
| <input type="checkbox"/> Peak Flow Basin | <input type="checkbox"/> Basement |
| <input type="checkbox"/> Manhole(s) | <input checked="" type="checkbox"/> Other (specify below) |

Identify **All** Incident Locations by Name, Street Address or Manhole Number as appropriate.
 We responded to a sewer call at 803 south 3rd street by Julie Claire for drains are slow to drain. The upstream manhole is 0350 and the downstream manhole is 0349.

8. Cause of Incident:
- | | |
|---|--|
| <input type="checkbox"/> Intentional Bypass for Repair/Construction | <input type="checkbox"/> Equipment Failure |
| <input type="checkbox"/> Excessive Rainfall, Snow Melt | <input type="checkbox"/> Control System Failure |
| <input type="checkbox"/> Unplanned Construction Related Break | <input type="checkbox"/> Power Related Failure |
| <input type="checkbox"/> City Line Break (Not Construction Related) | <input type="checkbox"/> Operations Related Failure |
| <input type="checkbox"/> City Line Blockage | <input type="checkbox"/> Maintenance Related Failure |
| <input type="checkbox"/> Private Line Break | <input type="checkbox"/> Vandalism |
| <input type="checkbox"/> Private Line Blockage | <input checked="" type="checkbox"/> Other |
| <input type="checkbox"/> Lagoon High Level | |

Additional explanation of reason for Incident: (use additional page if necessary)
 While working this Private line issue where there was no overflow in the house or outside our crew noticed that the creek water was dark and could smell what they thought was sewer.

9. Corrective Action, if any: (use additional page if necessary)
 We rodded the line for the original call and had no problems. We also cctv;d this line hoping to fine the cause of the sewer in the creek. We then dyed the line while pumping creek into the upstream manhole. We did not observe any dye going into the creek. Yesterday we dye tested six houses and still found nothing and had no dye into the creek. We believe now that someone had dumped their camping trailers gray water tank into the storm drain. The first e-coli test we took on May 17 was 19,000 and the e-coli test on May 22 was 5137.. We have removed the contaminated creek sign.

Name: Chuck Staples Date: 5/25/17

**KANSAS DEPARTMENT OF HEALTH AND ENVIRONMENT
WASTEWATER INCIDENT REPORT FORM**

Definitions are available at <http://www.kdheks.gov/water/tech.html>

Collection System Bypass In-Plant Diversion Upset In-Plant Flow Through Spill

1. FACILITY NAME: Leavenworth, City of Kansas Permit # M-MO12-IO01
2. Within 24 hours of discovery, notify the KDHE Central Office (email – cseeds@kdheks.gov), (fax 785.296.0086), (telephone 785.296.5517) or your local KDHE district office. Written notification is required within 5 days of discovery. If the incident is not corrected within 5 days, send a written notification to KDHE indicating the status. This form is to be sent to KDHE when the incident ends.

KDHE Person Contacted: Chris Seeds Date: 5/17/17 Time: 12:20 pm

3. Date Incident Discovered: 5/17/2017 Time: 8:50 am
4. Date Incident Ended: 5/19/2017 Time: 8:08 am
5. Total estimated gallons bypassed, spilled, or routed through failed equipment for all locations on this form: unknown
6. If rainfall induced event, approximate inches of rainfall n/a
 If multiple locations listed below due to rain event, check here

7. Incident Location: (check all that apply)
- | | |
|--|--|
| <input type="checkbox"/> Plant | <input type="checkbox"/> City Collection Line (Line Break / Joint) |
| <input type="checkbox"/> Lift/Pump Station | <input type="checkbox"/> Private Sewer Line |
| <input type="checkbox"/> Peak Flow Basin | <input checked="" type="checkbox"/> Basement |
| <input type="checkbox"/> Manhole(s) | <input type="checkbox"/> Other (specify below) |

Identify **All** Incident Locations by Name, Street Address or Manhole Number as appropriate.
1314 Cherokee overflow in basement drain. contained in basement drain.

8. Cause of Incident:
- | | |
|---|--|
| <input type="checkbox"/> Intentional Bypass for Repair/Construction | <input type="checkbox"/> Equipment Failure |
| <input type="checkbox"/> Excessive Rainfall, Snow Melt | <input type="checkbox"/> Control System Failure |
| <input type="checkbox"/> Unplanned Construction Related Break | <input type="checkbox"/> Power Related Failure |
| <input type="checkbox"/> City Line Break (Not Construction Related) | <input type="checkbox"/> Operations Related Failure |
| <input type="checkbox"/> City Line Blockage | <input type="checkbox"/> Maintenance Related Failure |
| <input type="checkbox"/> Private Line Break | <input type="checkbox"/> Vandalism |
| <input checked="" type="checkbox"/> Private Line Blockage | <input type="checkbox"/> Other |
| <input type="checkbox"/> Lagoon High Level | |

Additional explanation of reason for Incident: (use additional page if necessary)
City staff cleaned city main and found no problems advised homeowner of their findings

9. Corrective Action, if any: (use additional page if necessary)
Homeowner called plumber. Plumber cleared line.

Name: Tim Guardado Date: 5/19/17
Title: Assistant Superintendent Phone: 913-682-1090

When Completed, E-mail to: cseeds@kdheks.gov
Kansas Department of Health & Environment – Attn: Chris Seeds
Or Mail to: 1000 SW Jackson St., Suite 420, Topeka, KS 66612-1367
Fax 785.296.0086

**KANSAS DEPARTMENT OF HEALTH AND ENVIRONMENT
WASTEWATER INCIDENT REPORT FORM**

Definitions are available at <http://www.kdheks.gov/water/tech.html>

Collection System Bypass In-Plant Diversion Upset In-Plant Flow Through Spill

1. FACILITY NAME: Leavenworth, City of Kansas Permit # M-MO12-IO01

2. Within 24 hours of discovery, notify the KDHE Central Office (email – cseeds@kdheks.gov), (fax 785.296.0086), (telephone 785.296.5517) or your local KDHE district office. Written notification is required within 5 days of discovery. If the incident is not corrected within 5 days, send a written notification to KDHE indicating the status. This form is to be sent to KDHE when the incident ends.

KDHE Person Contacted: Chris Seeds Date: 3/31/17 Time: 1:51 pm

3. Date Incident Discovered: 3/30/2017 5/30/17 Time: 9:55 am

4. Date Incident Ended: 3/31/2017 5/31/17 Time: 9:00 am

5. Total estimated gallons bypassed, spilled, or routed through failed equipment for all locations on this form: unknown (contined in basement)

6. If rainfall induced event, approximate inches of rainfall n/a

If multiple locations listed below due to rain event, check here

7. Incident Location: (check all that apply)

- | | |
|--|--|
| <input type="checkbox"/> Plant | <input type="checkbox"/> City Collection Line (Line Break / Joint) |
| <input type="checkbox"/> Lift/Pump Station | <input type="checkbox"/> Private Sewer Line |
| <input type="checkbox"/> Peak Flow Basin | <input checked="" type="checkbox"/> Basement |
| <input type="checkbox"/> Manhole(s) | <input type="checkbox"/> Other (specify below) |

Identify **All** Incident Locations by Name, Street Address or Manhole Number as appropriate.

Cassidy Williams called stating she had water in her basement at 788 Charles St. The upstream manhole is 0480 and the downstream is 0479.

8. Cause of Incident:

- | | |
|---|--|
| <input type="checkbox"/> Intentional Bypass for Repair/Construction | <input type="checkbox"/> Equipment Failure |
| <input type="checkbox"/> Excessive Rainfall, Snow Melt | <input type="checkbox"/> Control System Failure |
| <input type="checkbox"/> Unplanned Construction Related Break | <input type="checkbox"/> Power Related Failure |
| <input type="checkbox"/> City Line Break (Not Construction Related) | <input type="checkbox"/> Operations Related Failure |
| <input type="checkbox"/> City Line Blockage | <input type="checkbox"/> Maintenance Related Failure |
| <input type="checkbox"/> Private Line Break | <input type="checkbox"/> Vandalism |
| <input checked="" type="checkbox"/> Private Line Blockage | <input type="checkbox"/> Other |
| <input type="checkbox"/> Lagoon High Level | |

Additional explanation of reason for Incident: (use additional page if necessary)

Upon arrival we checked the city main and had no problems. We rodded the line for 300 feet and there was no blockage.

9. Corrective Action, if any: (use additional page if necessary)

Once the city line were checked we contacted the owner and informed her that she needed to call a plumber. Mrs. Williams called this morning to inform us that the plumber had clean their line.

Name: Chuck Staples

Date: 5/31/17

Title: Superintendent

Phone: 913-682-1090

When Completed, E-mail to: cseeds@kdheks.gov

Kansas Department of Health & Environment – Attn: Chris Seeds

**KANSAS DEPARTMENT OF HEALTH AND ENVIRONMENT
WASTEWATER INCIDENT REPORT FORM**

Definitions are available at <http://www.kdheks.gov/water/tech.html>

Collection System Bypass In-Plant Diversion Upset In-Plant Flow Through Spill

1. FACILITY NAME: Leavenworth, City of Kansas Permit # M-MO12-IO01
2. Within 24 hours of discovery, notify the KDHE Central Office (email – cseeds@kdheks.gov), (fax 785.296.0086), (telephone 785.296.5517) or your local KDHE district office. Written notification is required within 5 days of discovery. If the incident is not corrected within 5 days, send a written notification to KDHE indicating the status. This form is to be sent to KDHE when the incident ends.

KDHE Person Contacted: Chris Seeds Date: 5/31/17 Time: 1:09 pm

3. Date Incident Discovered: 5/30/2017 Time: 10:30 am

4. Date Incident Ended: 5/30/2017 Time: 3:00 pm

5. Total estimated gallons bypassed, spilled, or routed through failed equipment for all locations on this form: unknown contained in structure

6. If rainfall induced event, approximate inches of rainfall n/a

If multiple locations listed below due to rain event, check here

7. Incident Location: (check all that apply)

- | | |
|--|--|
| <input type="checkbox"/> Plant | <input type="checkbox"/> City Collection Line (Line Break / Joint) |
| <input type="checkbox"/> Lift/Pump Station | <input type="checkbox"/> Private Sewer Line |
| <input type="checkbox"/> Peak Flow Basin | <input checked="" type="checkbox"/> Basement |
| <input type="checkbox"/> Manhole(s) | <input type="checkbox"/> Other (specify below) |

Identify **All** Incident Locations by Name, Street Address or Manhole Number as appropriate.

Mr. Blake called stating that he had water in their business at 316 north 4th street. The upstream manhole is 0196.1 and the downstream is 0197.

8. Cause of Incident:

- | | |
|---|--|
| <input type="checkbox"/> Intentional Bypass for Repair/Construction | <input type="checkbox"/> Equipment Failure |
| <input type="checkbox"/> Excessive Rainfall, Snow Melt | <input type="checkbox"/> Control System Failure |
| <input type="checkbox"/> Unplanned Construction Related Break | <input type="checkbox"/> Power Related Failure |
| <input type="checkbox"/> City Line Break (Not Construction Related) | <input type="checkbox"/> Operations Related Failure |
| <input checked="" type="checkbox"/> City Line Blockage | <input type="checkbox"/> Maintenance Related Failure |
| <input type="checkbox"/> Private Line Break | <input type="checkbox"/> Vandalism |
| <input type="checkbox"/> Private Line Blockage | <input type="checkbox"/> Other |
| <input type="checkbox"/> Lagoon High Level | |

Additional explanation of reason for Incident: (use additional page if necessary)

At this location the downstream manhole is a flush tank so we need to access from the upstream and the line there is partially collapsed. This collapsed line is causing this line to back up.

9. Corrective Action, if any: (use additional page if necessary)

"We used our small flush truck and was able to open this line up. We have requested a contract to repair this line but no approval as of this date."

Name: Chuck Staples Date: 5/31/17

Title: Superintendent Phone: 913-682-1090

When Completed, E-mail to: cseeds@kdheks.gov
Kansas Department of Health & Environment – Attn: Chris Seeds

**KANSAS DEPARTMENT OF HEALTH AND ENVIRONMENT
WASTEWATER INCIDENT REPORT FORM**

Definitions are available at <http://www.kdheks.gov/water/tech.html>

Collection System Bypass In-Plant Diversion Upset In-Plant Flow Through Spill

1. FACILITY NAME: Leavenworth, City of Kansas Permit # M-MO12-IO01
2. Within 24 hours of discovery, notify the KDHE Central Office (email – cseeds@kdheks.gov), (fax 785.296.0086), (telephone 785.296.5517) or your local KDHE district office. Written notification is required within 5 days of discovery. If the incident is not corrected within 5 days, send a written notification to KDHE indicating the status. This form is to be sent to KDHE when the incident ends.

KDHE Person Contacted: Chris Seeds Date: 5/31/17 Time: 10:12 am

3. Date Incident Discovered: 5/30/2017 Time: 8:30 am
4. Date Incident Ended: 5/30/2017 Time: 9:21 am
5. Total estimated gallons bypassed, spilled, or routed through failed equipment for all locations on this form: unknown(estimated 600 gallons upon arrival)
6. If rainfall induced event, approximate inches of rainfall n/a
If multiple locations listed below due to rain event, check here

7. Incident Location: (check all that apply)

- | | |
|--|--|
| <input type="checkbox"/> Plant | <input type="checkbox"/> City Collection Line (Line Break / Joint) |
| <input type="checkbox"/> Lift/Pump Station | <input type="checkbox"/> Private Sewer Line |
| <input type="checkbox"/> Peak Flow Basin | <input type="checkbox"/> Basement |
| <input checked="" type="checkbox"/> Manhole(s) | <input type="checkbox"/> Other (specify below) |

Identify **All** Incident Locations by Name, Street Address or Manhole Number as appropriate.
Fred who lives at 524 Elizabeth Street call stating that a manhole was overflowing behind his house. The upstream manhole is 0592 and the downstream is 0596.

8. Cause of Incident:

- | | |
|---|--|
| <input type="checkbox"/> Intentional Bypass for Repair/Construction | <input type="checkbox"/> Equipment Failure |
| <input type="checkbox"/> Excessive Rainfall, Snow Melt | <input type="checkbox"/> Control System Failure |
| <input type="checkbox"/> Unplanned Construction Related Break | <input type="checkbox"/> Power Related Failure |
| <input type="checkbox"/> City Line Break (Not Construction Related) | <input type="checkbox"/> Operations Related Failure |
| <input checked="" type="checkbox"/> City Line Blockage | <input type="checkbox"/> Maintenance Related Failure |
| <input type="checkbox"/> Private Line Break | <input type="checkbox"/> Vandalism |
| <input type="checkbox"/> Private Line Blockage | <input type="checkbox"/> Other |
| <input type="checkbox"/> Lagoon High Level | |

Additional explanation of reason for Incident: (use additional page if necessary)

We rodded from the down stream manhole and hit a blockage at 200 feet. Once the nozzle broke through the water started to recede.

9. Corrective Action, if any: (use additional page if necessary)

Once the manhole was flowing normal we cleaned up around the manhole and placed contaminated Creel sign out. We also had a e-coli sample taken upstream and downstream and sent a report for the City of Leavenworths web site for our residents.

Name: Chuck Staples Date: 5/31/17
Title: Superintendent Phone: 913-682-1090

When Completed, E-mail to: cseeds@kdheks.gov

**KANSAS DEPARTMENT OF HEALTH AND ENVIRONMENT
WASTEWATER INCIDENT REPORT FORM**

Definitions are available at <http://www.kdheks.gov/water/tech.html>

Collection System Bypass In-Plant Diversion Upset In-Plant Flow Through Spill

1. FACILITY NAME: Leavenworth, City of Kansas Permit # M-MO12-IO01
 2. Within 24 hours of discovery, notify the KDHE Central Office (email – cseeds@kdheks.gov), (fax 785.296.0086), (telephone 785.296.5517) or your local KDHE district office. Written notification is required within 5 days of discovery. If the incident is not corrected within 5 days, send a written notification to KDHE indicating the status. This form is to be sent to KDHE when the incident ends.

KDHE Person Contacted: Chris Seeds Date: 6/1/17 Time: 12:21 pm

3. Date Incident Discovered: 5/30/2017 Time: 4:25 pm
 4. Date Incident Ended: 6/1/2017 Time: 12:00pm
 5. Total estimated gallons bypassed, spilled, or routed through failed equipment for all locations on this form: 5-10 gallons
 6. If rainfall induced event, approximate inches of rainfall n/a
 If multiple locations listed below due to rain event, check here

7. Incident Location: (check all that apply)
- | | |
|--|--|
| <input type="checkbox"/> Plant | <input type="checkbox"/> City Collection Line (Line Break / Joint) |
| <input type="checkbox"/> Lift/Pump Station | <input checked="" type="checkbox"/> Private Sewer Line |
| <input type="checkbox"/> Peak Flow Basin | <input type="checkbox"/> Basement |
| <input type="checkbox"/> Manhole(s) | <input type="checkbox"/> Other (specify below) |

Identify **All** Incident Locations by Name, Street Address or Manhole Number as appropriate.
 The owner of 400 Grand called stating that their lateral was backed up and water was running down the street. The upstream manhole is 0295 and the downstream manhole is 0294

8. Cause of Incident:
- | | |
|---|--|
| <input type="checkbox"/> Intentional Bypass for Repair/Construction | <input type="checkbox"/> Equipment Failure |
| <input type="checkbox"/> Excessive Rainfall, Snow Melt | <input type="checkbox"/> Control System Failure |
| <input type="checkbox"/> Unplanned Construction Related Break | <input type="checkbox"/> Power Related Failure |
| <input type="checkbox"/> City Line Break (Not Construction Related) | <input type="checkbox"/> Operations Related Failure |
| <input type="checkbox"/> City Line Blockage | <input type="checkbox"/> Maintenance Related Failure |
| <input type="checkbox"/> Private Line Break | <input type="checkbox"/> Vandalism |
| <input checked="" type="checkbox"/> Private Line Blockage | <input type="checkbox"/> Other |
| <input type="checkbox"/> Lagoon High Level | |

Additional explanation of reason for Incident: (use additional page if necessary)
 Upon arrival we checked our line and rodded 136 feet with no problems. Since there was another clean out next to the 400 Grand clean out we checked to see if water was in that clean out and found it was dry.

9. Corrective Action, if any: (use additional page if necessary)
 We informed the owner that they needed to call a plumber and ask them to refrain from using water. The owner contacted our inspection branch this morning and informed him that their line was open

Name: Chuck Staples Date: 6/01/17
 Title: Superintendent Phone: 913-682-1090

When Completed, E-mail to: cseeds@kdheks.gov

**KANSAS DEPARTMENT OF HEALTH AND ENVIRONMENT
WASTEWATER INCIDENT REPORT FORM**

Definitions are available at <http://www.kdheks.gov/water/tech.html>

Collection System Bypass In-Plant Diversion Upset In-Plant Flow Through Spill

1. FACILITY NAME: Leavenworth, City of Kansas Permit # M-MO12-IO01
 2. Within 24 hours of discovery, notify the KDHE Central Office (email – cseeds@kdheks.gov), (fax 785.296.0086), (telephone 785.296.5517) or your local KDHE district office. Written notification is required within 5 days of discovery. If the incident is not corrected within 5 days, send a written notification to KDHE indicating the status. This form is to be sent to KDHE when the incident ends.

KDHE Person Contacted: Chris Seeds Date: 6/8/17 Time: 2:47 pm

3. Date Incident Discovered: 5/30/2017 Time: 12:40 pm

4. Date Incident Ended: 6/8/2017 Time: 11:21 pm

5. Total estimated gallons bypassed, spilled, or routed through failed equipment for all locations on this form: unknown estimated 5 gallons

6. If rainfall induced event, approximate inches of rainfall n/a

If multiple locations listed below due to rain event, check here

7. Incident Location: (check all that apply)

- | | |
|--|--|
| <input type="checkbox"/> Plant | <input type="checkbox"/> City Collection Line (Line Break / Joint) |
| <input type="checkbox"/> Lift/Pump Station | <input checked="" type="checkbox"/> Private Sewer Line |
| <input type="checkbox"/> Peak Flow Basin | <input type="checkbox"/> Basement |
| <input type="checkbox"/> Manhole(s) | <input type="checkbox"/> Other (specify below) |

Identify **All** Incident Locations by Name, Street Address or Manhole Number as appropriate.

Megan Weyer called stating her drains were backing up at ~~1501~~ 1504 5th Ave. The upstream manhole is 0541 and the downstream manhole is 0537. This is a private line issue. 1504 5th Av.

8. Cause of Incident:

- | | |
|---|--|
| <input type="checkbox"/> Intentional Bypass for Repair/Construction | <input type="checkbox"/> Equipment Failure |
| <input type="checkbox"/> Excessive Rainfall, Snow Melt | <input type="checkbox"/> Control System Failure |
| <input type="checkbox"/> Unplanned Construction Related Break | <input type="checkbox"/> Power Related Failure |
| <input type="checkbox"/> City Line Break (Not Construction Related) | <input type="checkbox"/> Operations Related Failure |
| <input type="checkbox"/> City Line Blockage | <input type="checkbox"/> Maintenance Related Failure |
| <input type="checkbox"/> Private Line Break | <input type="checkbox"/> Vandalism |
| <input checked="" type="checkbox"/> Private Line Blockage | <input type="checkbox"/> Other |
| <input type="checkbox"/> Lagoon High Level | |

Additional explanation of reason for Incident: (use additional page if necessary)

Upon arrival we checked our line and had good flow. We rodded 450 feet without problems and notified the owner that they needed to call a plumber. There was no water on the ground.

9. Corrective Action, if any: (use additional page if necessary)

We called the owner and they had a plumber coming and then the plumber was cancelled. We checked this location several times in case clean up was needed. We were called by or plumbing inspector this morning that a new clean out had been installed.

Name: Chuck Staples Date: 6/08/17

Title: Superintendent Phone: 913-682-1090

When Completed, E-mail to: cseeds@kdheks.gov

June

2017

**KANSAS DEPARTMENT OF HEALTH AND ENVIRONMENT
WASTEWATER INCIDENT REPORT FORM**

Definitions are available at <http://www.kdheks.gov/water/tech.html>

Collection System Bypass In-Plant Diversion Upset In-Plant Flow Through Spill

1. FACILITY NAME: Leavenworth, City of Kansas Permit # M-MO12-IO01
2. Within 24 hours of discovery, notify the KDHE Central Office (email – cseeds@kdheks.gov), (fax 785.296.0086), (telephone 785.296.5517) or your local KDHE district office. Written notification is required within 5 days of discovery. If the incident is not corrected within 5 days, send a written notification to KDHE indicating the status. This form is to be sent to KDHE when the incident ends.

KDHE Person Contacted: Chris Seeds Date: 6/12/17 Time: 9:37 am

3. Date Incident Discovered: 6/5/2017 Time: 3:00 pm
4. Date Incident Ended: 6/12/2017 Time: 8:15 am
5. Total estimated gallons bypassed, spilled, or routed through failed equipment for all locations on this form: 5 gallons
6. If rainfall induced event, approximate inches of rainfall n/a

If multiple locations listed below due to rain event, check here

7. Incident Location: (check all that apply)

- | | |
|--|--|
| <input type="checkbox"/> Plant | <input type="checkbox"/> City Collection Line (Line Break / Joint) |
| <input type="checkbox"/> Lift/Pump Station | <input checked="" type="checkbox"/> Private Sewer Line |
| <input type="checkbox"/> Peak Flow Basin | <input type="checkbox"/> Basement |
| <input type="checkbox"/> Manhole(s) | <input type="checkbox"/> Other (specify below) |

Identify **All** Incident Locations by Name, Street Address or Manhole Number as appropriate.

Justin Steward one of the Cities Engineering Tech call stating that the lateral at 1209 Spruce Street was overflowing . The upstream manhole is 4115.1 and the downstream is 0410.

8. Cause of Incident:

- | | |
|---|--|
| <input type="checkbox"/> Intentional Bypass for Repair/Construction | <input type="checkbox"/> Equipment Failure |
| <input type="checkbox"/> Excessive Rainfall, Snow Melt | <input type="checkbox"/> Control System Failure |
| <input type="checkbox"/> Unplanned Construction Related Break | <input type="checkbox"/> Power Related Failure |
| <input type="checkbox"/> City Line Break (Not Construction Related) | <input type="checkbox"/> Operations Related Failure |
| <input type="checkbox"/> City Line Blockage | <input type="checkbox"/> Maintenance Related Failure |
| <input checked="" type="checkbox"/> Private Line Break | <input type="checkbox"/> Vandalism |
| <input type="checkbox"/> Private Line Blockage | <input type="checkbox"/> Other |
| <input type="checkbox"/> Lagoon High Level | |

Additional explanation of reason for Incident: (use additional page if necessary)

Upon arrival we checked our lines and hold no problems. We tried to make contact with the resident but could not. We left a door hanger asking the resident to call the Treatment Plant as soon as possible. We finally make contact in person the next day as we where checking on this overflow.

9. Corrective Action, if any: (use additional page if necessary)

Once we checked our lines we cleaned up the area and placed containment socks to protect a storm drain nearby. No water ever reached this storm drain. The owner contacted our plumbing inspector this morning stating the line was open.

Name: Chuck Staples Date: 6/12/17
Title: Superintendent Phone: 913-682-1090

COPY

C18
KDHE sent
6/6/17

KANSAS DEPARTMENT OF HEALTH AND ENVIRONMENT
WASTEWATER INCIDENT REPORT FORM

Definitions are available at <http://www.kdheks.gov/water/tech.html>

Collection System Bypass In-Plant Diversion Upset In-Plant Flow Through Spill Power Related

1. FACILITY NAME: Leavenworth, City of Kansas Permit # M-MO12-IO01

2. Within 24 hours of discovery, notify the KDHE Central Office (email – cseeds@kdheks.gov), (fax 785.296.0086), (telephone 785.296.5517) or your local KDHE district office. Written notification is required within 5 days of discovery. If the incident is not corrected within 5 days, send a written notification to KDHE indicating the status. This form is to be sent to KDHE when the incident ends.

KDHE Person Contacted: Chris Seeds Date: 6/6/17 Time: 10:28 am

3. Date Incident Discovered: 6/6/2017 Time: 8:49 am

4. Date Incident Ended: 6/6/2017 Time: 8:51 am

5. Total estimated gallons bypassed, spilled, or routed through failed equipment for all locations on this form: 4,150 gallons

6. If rainfall induced event, approximate inches of rainfall n/a

If multiple locations listed below due to rain event, check here

7. Incident Location: (check all that apply)

- | | |
|--|--|
| <input checked="" type="checkbox"/> Plant | <input type="checkbox"/> City Collection Line (Line Break / Joint) |
| <input type="checkbox"/> Lift/Pump Station | <input type="checkbox"/> Private Sewer Line |
| <input type="checkbox"/> Peak Flow Basin | <input type="checkbox"/> Basement |
| <input type="checkbox"/> Manhole(s) | <input type="checkbox"/> Other (specify below) |

Identify **All** Incident Locations by Name, Street Address or Manhole Number as appropriate.

Mark called stating that the plant had a power failure at 1800 South 2nd Steet. The in-plant flow through happened at the UV building.

8. Cause of Incident:

- | | |
|---|---|
| <input type="checkbox"/> Intentional Bypass for Repair/Construction | <input type="checkbox"/> Equipment Failure |
| <input type="checkbox"/> Excessive Rainfall, Snow Melt | <input type="checkbox"/> Control System Failure |
| <input type="checkbox"/> Unplanned Construction Related Break | <input checked="" type="checkbox"/> Power Related Failure |
| <input type="checkbox"/> City Line Break (Not Construction Related) | <input type="checkbox"/> Operations Related Failure |
| <input type="checkbox"/> City Line Blockage | <input type="checkbox"/> Maintenance Related Failure |
| <input type="checkbox"/> Private Line Break | <input type="checkbox"/> Vandalism |
| <input type="checkbox"/> Private Line Blockage | <input type="checkbox"/> Other |
| <input type="checkbox"/> Lagoon High Level | |

Additional explanation of reason for Incident: (use additional page if necessary)

A transformer blew up at Grand and Ohio Street causing the power at the plant to momentarily drop out. The UV lamps were out and then came back on but for that two minutes the Treatment plant was not disinfection our effluent.

9. Corrective Action, if any: (use additional page if necessary)

Power was restarted and the UV lamp came on and everything was back to normal

Name: Chuck Staples Date: 6/06/17

Title: Superintendent Phone: 913-682-1090

When Completed, E-mail to: cseeds@kdheks.gov

Kansas Department of Health & Environment – Attn: Chris Seeds

**KANSAS DEPARTMENT OF HEALTH AND ENVIRONMENT
WASTEWATER INCIDENT REPORT FORM**

Definitions are available at <http://www.kdheks.gov/water/tech.html>

Collection System Bypass In-Plant Diversion Upset In-Plant Flow Through Spill

1. FACILITY NAME: Leavenworth, City of Kansas Permit # M-MO12-IO01
2. Within 24 hours of discovery, notify the KDHE Central Office (email – cseeds@kdheks.gov), (fax 785.296.0086), (telephone 785.296.5517) or your local KDHE district office. Written notification is required within 5 days of discovery. If the incident is not corrected within 5 days, send a written notification to KDHE indicating the status. This form is to be sent to KDHE when the incident ends.

KDHE Person Contacted: Chris Seeds Date: 6/7/17 Time: 3:15 pm

3. Date Incident Discovered: 6/6/2017 Time: 8:20 am
4. Date Incident Ended: 6/7/2017 Time: 2:30 pm
5. Total estimated gallons bypassed, spilled, or routed through failed equipment for all locations on this form: one gallon
6. If rainfall induced event, approximate inches of rainfall n/a
 If multiple locations listed below due to rain event, check here

7. Incident Location: (check all that apply)
- | | |
|--|--|
| <input type="checkbox"/> Plant | <input type="checkbox"/> City Collection Line (Line Break / Joint) |
| <input type="checkbox"/> Lift/Pump Station | <input checked="" type="checkbox"/> Private Sewer Line |
| <input type="checkbox"/> Peak Flow Basin | <input type="checkbox"/> Basement |
| <input type="checkbox"/> Manhole(s) | <input type="checkbox"/> Other (specify below) |

Identify **All** Incident Locations by Name, Street Address or Manhole Number as appropriate.
Contractor had hit a private sewer line at 423 Chestnut. There is no upstream or downstream manhole due to this is a private line in the alley.

8. Cause of Incident:
- | | |
|--|--|
| <input type="checkbox"/> Intentional Bypass for Repair/Construction | <input type="checkbox"/> Equipment Failure |
| <input type="checkbox"/> Excessive Rainfall, Snow Melt | <input type="checkbox"/> Control System Failure |
| <input checked="" type="checkbox"/> Unplanned Construction Related Break | <input type="checkbox"/> Power Related Failure |
| <input type="checkbox"/> City Line Break (Not Construction Related) | <input type="checkbox"/> Operations Related Failure |
| <input type="checkbox"/> City Line Blockage | <input type="checkbox"/> Maintenance Related Failure |
| <input type="checkbox"/> Private Line Break | <input type="checkbox"/> Vandalism |
| <input type="checkbox"/> Private Line Blockage | <input type="checkbox"/> Other |
| <input type="checkbox"/> Lagoon High Level | |

Additional explanation of reason for Incident: (use additional page if necessary)
Contractor damaged this lateral and then contacted the Church they was working for. The Church contacted a plumber.

9. Corrective Action, if any: (use additional page if necessary)
The plumber called in locates and fixed the line this afternoon.

Name: Chuck Staples Date: 6/07/17
Title: Superintendent Phone: 913-682-1090

When Completed, E-mail to: cseeds@kdheks.gov
Kansas Department of Health & Environment – Attn: Chris Seeds
Or Mail to: 1000 SW Jackson St., Suite 420, Topeka , KS 66612-1367

**KANSAS DEPARTMENT OF HEALTH AND ENVIRONMENT
WASTEWATER INCIDENT REPORT FORM**

Definitions are available at <http://www.kdheks.gov/water/tech.html>

Collection System Bypass In-Plant Diversion Upset In-Plant Flow Through Spill

1. FACILITY NAME: Leavenworth, City of Kansas Permit # M-MO12-IO01
 2. Within 24 hours of discovery, notify the KDHE Central Office (email – cseeds@kdheks.gov), (fax 785.296.0086), (telephone 785.296.5517) or your local KDHE district office. Written notification is required within 5 days of discovery. If the incident is not corrected within 5 days, send a written notification to KDHE indicating the status. This form is to be sent to KDHE when the incident ends.

KDHE Person Contacted: Chris Seeds Date: 6/8/17 Time: 2:46 pm

3. Date Incident Discovered: 6/6/2017 Time: 8:30 am

4. Date Incident Ended: 6/8/2017 Time: 10:00 am

5. Total estimated gallons bypassed, spilled, or routed through failed equipment for all locations on this form: unknown just debris on ground

6. If rainfall induced event, approximate inches of rainfall n/a

If multiple locations listed below due to rain event, check here

7. Incident Location: (check all that apply)

- | | |
|--|--|
| <input type="checkbox"/> Plant | <input type="checkbox"/> City Collection Line (Line Break / Joint) |
| <input type="checkbox"/> Lift/Pump Station | <input checked="" type="checkbox"/> Private Sewer Line |
| <input type="checkbox"/> Peak Flow Basin | <input type="checkbox"/> Basement |
| <input type="checkbox"/> Manhole(s) | <input type="checkbox"/> Other (specify below) |

Identify **All** Incident Locations by Name, Street Address or Manhole Number as appropriate.

While preparing to dye test our crew noticed debris on the ground around the clean out at 603 Ottawa Street. The upstream manhole is 0165.1 and the downstream manhole is 0165.2.

8. Cause of Incident:

- | | |
|---|--|
| <input type="checkbox"/> Intentional Bypass for Repair/Construction | <input type="checkbox"/> Equipment Failure |
| <input type="checkbox"/> Excessive Rainfall, Snow Melt | <input type="checkbox"/> Control System Failure |
| <input type="checkbox"/> Unplanned Construction Related Break | <input type="checkbox"/> Power Related Failure |
| <input type="checkbox"/> City Line Break (Not Construction Related) | <input type="checkbox"/> Operations Related Failure |
| <input type="checkbox"/> City Line Blockage | <input type="checkbox"/> Maintenance Related Failure |
| <input type="checkbox"/> Private Line Break | <input type="checkbox"/> Vandalism |
| <input checked="" type="checkbox"/> Private Line Blockage | <input type="checkbox"/> Other |
| <input type="checkbox"/> Lagoon High Level | |

Additional explanation of reason for Incident: (use additional page if necessary)

We checked our line and had no issues so we tried to contact the owner but knowone was home. We left a doorhanger. We was able to contact the resident later in the day and then we contacted the owner and informed him he needed to call a plumber.

9. Corrective Action, if any: (use additional page if necessary)

The owner a Darin Neas contacted us and wanted to know if there was two housed connected to one lateral. I infomed him that once his line was cleaned out we could dye test both laterals. He call at 10:00 this morning to say his lateral was flowing. We will set up a dye test for next week.

Name: Chuck Staples Date: 6/08/07
 Title: Superintendent Phone 913-682-1090

**KANSAS DEPARTMENT OF HEALTH AND ENVIRONMENT
WASTEWATER INCIDENT REPORT FORM**

Definitions are available at <http://www.kdheks.gov/water/tech.html>

Collection System Bypass In-Plant Diversion Upset In-Plant Flow Through Spill

1. FACILITY NAME: Leavenworth, City of Kansas Permit # M-MO12-1001
 2. Within 24 hours of discovery, notify the KDHE Central Office (email – cseeds@kdheks.gov), (fax 785.296.0086), (telephone 785.296.5517) or your local KDHE district office. Written notification is required within 5 days of discovery. If the incident is not corrected within 5 days, send a written notification to KDHE indicating the status. This form is to be sent to KDHE when the incident ends.

KDHE Person Contacted: Chris Seeds Date: 6/8/17 Time: 3:08 pm

3. Date Incident Discovered: 6/7/2017 Time: 10:00 pm
 4. Date Incident Ended: 6/8/2017 Time: 1:00 pm
 5. Total estimated gallons bypassed, spilled, or routed through failed equipment for all locations on this form: Contained in basement
 6. If rainfall induced event, approximate inches of rainfall n/a
 If multiple locations listed below due to rain event, check here

7. Incident Location: (check all that apply)
- | | |
|--|--|
| <input type="checkbox"/> Plant | <input type="checkbox"/> City Collection Line (Line Break / Joint) |
| <input type="checkbox"/> Lift/Pump Station | <input type="checkbox"/> Private Sewer Line |
| <input type="checkbox"/> Peak Flow Basin | <input checked="" type="checkbox"/> Basement |
| <input type="checkbox"/> Manhole(s) | <input type="checkbox"/> Other (specify below) |

Identify **All** Incident Locations by Name, Street Address or Manhole Number as appropriate.
 Russell Pruitt called stating his basement drain was backing up at 1007 Central Ave. The upstream manhole is 0479 and the downstream is 0478. This is a private line issue

8. Cause of Incident:
- | | |
|---|--|
| <input type="checkbox"/> Intentional Bypass for Repair/Construction | <input type="checkbox"/> Equipment Failure |
| <input type="checkbox"/> Excessive Rainfall, Snow Melt | <input type="checkbox"/> Control System Failure |
| <input type="checkbox"/> Unplanned Construction Related Break | <input type="checkbox"/> Power Related Failure |
| <input type="checkbox"/> City Line Break (Not Construction Related) | <input type="checkbox"/> Operations Related Failure |
| <input type="checkbox"/> City Line Blockage | <input type="checkbox"/> Maintenance Related Failure |
| <input type="checkbox"/> Private Line Break | <input type="checkbox"/> Vandalism |
| <input checked="" type="checkbox"/> Private Line Blockage | <input type="checkbox"/> Other |
| <input type="checkbox"/> Lagoon High Level | |

Additional explanation of reason for Incident: (use additional page if necessary)
 upon arrival we rodded our line for 320 feet with no problems and there was no water in any of the two manholes.

9. Corrective Action, if any: (use additional page if necessary)
 After checking our lines we informed the owner that he needed to call a plumber. I checked with Mr. Pruitt this afternoon and he said that (Walt Plumbing) rodded his line around 1:00 pm today to open it up.

Name: Chuck Staples Date: 6/08/17
 Title: Superintendent Phone: 913-682-1090

When Completed, E-mail to: cseeds@kdheks.gov

**KANSAS DEPARTMENT OF HEALTH AND ENVIRONMENT
WASTEWATER INCIDENT REPORT FORM**

Definitions are available at <http://www.kdheks.gov/water/tech.html>

Collection System Bypass In-Plant Diversion Upset In-Plant Flow Through Spill

1. FACILITY NAME: USP LEAVENWORTH Kansas Permit # FMO12PO06
2. Within 24 hours of discovery, notify the KDHE Central Office (email – cseeds@kdheks.gov), (fax 785.296.0086), (telephone 785.296.5517) or your local KDHE district office. Written notification is required within 5 days of discovery. If the incident is not corrected within 5 days, send a written notification to KDHE indicating the status. This form is to be sent to KDHE when the incident ends.

**IF THE INCIDENT IS AFTER HOURS AND REPRESENTS A SIGNIFICANT
PUBLIC HEALTH THREAT CALL 785.296.1679 IMMEDIATELY**

KDHE Person Contacted: HELEN HOLME Date: 6/12/17 Time: 9:15 AM

3. Date Incident Discovered: 6/9/2017 Time: 11:45 AM
4. Date Incident Ended: 6/9/2017 Time: 12:00 PM
5. Total estimated gallons bypassed, spilled, or routed through failed equipment for all locations on this form: 50 GALLONS
6. If rainfall induced event, approximate inches of rainfall _____
If multiple locations listed below due to rain event, check here

7. Incident Location: (check all that apply)
- | | |
|---|--|
| <input type="checkbox"/> Plant | <input type="checkbox"/> City Collection Line (Line Break / Joint) |
| <input checked="" type="checkbox"/> Lift/Pump Station | <input type="checkbox"/> Private Sewer Line |
| <input type="checkbox"/> Peak Flow Basin | <input type="checkbox"/> Basement |
| <input type="checkbox"/> Manhole(s) | <input type="checkbox"/> Other (specify below) |

Identify **All** Incident Locations by Name, Street Address or Manhole Number as appropriate.
LIFT STATION LOCATED ON 1300 METROPOLITAN AVE

8. Cause of Incident:
- | | |
|---|---|
| <input type="checkbox"/> Intentional Bypass for Repair/Construction | <input checked="" type="checkbox"/> Equipment Failure |
| <input type="checkbox"/> Excessive Rainfall, Snow Melt | <input type="checkbox"/> Control System Failure |
| <input type="checkbox"/> Unplanned Construction Related Break | <input type="checkbox"/> Power Related Failure |
| <input type="checkbox"/> City Line Break (Not Construction Related) | <input type="checkbox"/> Operations Related Failure |
| <input type="checkbox"/> City Line Blockage | <input type="checkbox"/> Maintenance Related Failure |
| <input type="checkbox"/> Private Line Break | <input type="checkbox"/> Vandalism |
| <input type="checkbox"/> Private Line Blockage | <input type="checkbox"/> Other |
| <input type="checkbox"/> Lagoon High Level | |

Additional explanation of reason for Incident: (use additional page if necessary)
WHEN THE #1 PUMP WENT DOWN THE Back UP DID NOT TURN ON.

9. Corrective Action, if any: (use additional page if necessary)
WE ARE ORDERING NEW PUMPS AND UPDATING BREAKER BOXES

Name: BILLYE E CORDELL Date: 6/12/2017
Title: SAFETY MANAGER Phone: 913-578-1387

When Completed, E-mail to: cseeds@kdheks.gov
Kansas Department of Health & Environment – Attn: Chris Seeds
Or Mail to: 1000 SW Jackson St., Suite 420, Topeka , KS 66612-1367
Fax 785.296.0086

**KANSAS DEPARTMENT OF HEALTH AND ENVIRONMENT
WASTEWATER INCIDENT REPORT FORM**

Definitions are available at <http://www.kdheks.gov/water/tech.html>

Collection System Bypass In-Plant Diversion Upset In-Plant Flow Through Spill

1. FACILITY NAME: Leavenworth, City of Kansas Permit # M-MO12-IO01
2. Within 24 hours of discovery, notify the KDHE Central Office (email – cseeds@kdheks.gov), (fax 785.296.0086), (telephone 785.296.5517) or your local KDHE district office. Written notification is required within 5 days of discovery. If the incident is not corrected within 5 days, send a written notification to KDHE indicating the status. This form is to be sent to KDHE when the incident ends.

KDHE Person Contacted: Chris Seeds Date: 6/12/17 Time: 3:49 pm

3. Date Incident Discovered: 6/9/2017 Time: 4:30 pm
4. Date Incident Ended: 6/12/2017 Time: 3:00 pm
5. Total estimated gallons bypassed, spilled, or routed through failed equipment for all locations on this form: unknown contained in basement
6. If rainfall induced event, approximate inches of rainfall n/a

If multiple locations listed below due to rain event, check here

7. Incident Location: (check all that apply)

- | | |
|--|--|
| <input type="checkbox"/> Plant | <input type="checkbox"/> City Collection Line (Line Break / Joint) |
| <input type="checkbox"/> Lift/Pump Station | <input type="checkbox"/> Private Sewer Line |
| <input type="checkbox"/> Peak Flow Basin | <input checked="" type="checkbox"/> Basement |
| <input type="checkbox"/> Manhole(s) | <input type="checkbox"/> Other (specify below) |

Identify **All** Incident Locations by Name, Street Address or Manhole Number as appropriate.

Ray Rodriques called stating his basement was backing up with water at 707 south 6th street. The upstream manhole is 0336.1 and the downstream is 0336.

8. Cause of Incident:

- | | |
|---|--|
| <input type="checkbox"/> Intentional Bypass for Repair/Construction | <input type="checkbox"/> Equipment Failure |
| <input type="checkbox"/> Excessive Rainfall, Snow Melt | <input type="checkbox"/> Control System Failure |
| <input type="checkbox"/> Unplanned Construction Related Break | <input type="checkbox"/> Power Related Failure |
| <input type="checkbox"/> City Line Break (Not Construction Related) | <input type="checkbox"/> Operations Related Failure |
| <input type="checkbox"/> City Line Blockage | <input type="checkbox"/> Maintenance Related Failure |
| <input type="checkbox"/> Private Line Break | <input type="checkbox"/> Vandalism |
| <input checked="" type="checkbox"/> Private Line Blockage | <input type="checkbox"/> Other |
| <input type="checkbox"/> Lagoon High Level | |

Additional explanation of reason for Incident: (use additional page if necessary)

Upon arrival we checked our lines and then rodded 418 feet with no problems. We were not allowed access to the basement so we informed the owner that they needed to call a plumber.

9. Corrective Action, if any: (use additional page if necessary)

After informing the owner that they needed to call a plumber we also asked if they could call us when the line is open. We got the call this afternoon.

Name: Chuck Staples Date: 6/12/17
Title: Superintendent Phone: 913-682-1090

When Completed, E-mail to: cseeds@kdheks.gov
Kansas Department of Health & Environment – Attn: Chris Seeds

**KANSAS DEPARTMENT OF HEALTH AND ENVIRONMENT
WASTEWATER INCIDENT REPORT FORM**

Definitions are available at <http://www.kdheks.gov/water/tech.html>

Collection System Bypass In-Plant Diversion Upset In-Plant Flow Through Spill

1. FACILITY NAME: Leavenworth, City of Kansas Permit # M-MO12-IO01
 2. Within 24 hours of discovery, notify the KDHE Central Office (email – cseeds@kdheks.gov), (fax 785.296.0086), (telephone 785.296.5517) or your local KDHE district office. Written notification is required within 5 days of discovery. If the incident is not corrected within 5 days, send a written notification to KDHE indicating the status. This form is to be sent to KDHE when the incident ends.

KDHE Person Contacted: Chris Seeds Date: 6/19/17 Time: 1130 hour

3. Date Incident Discovered: 6/19/2017 Time: 0645 hours
 4. Date Incident Ended: 6/19/2017 Time: 0925 hour
 5. Total estimated gallons bypassed, spilled, or routed through failed equipment for all locations on this form: _____
 6. If rainfall induced event, approximate inches of rainfall n/a
 If multiple locations listed below due to rain event, check here

7. Incident Location: (check all that apply)
 Plant City Collection Line (Line Break / Joint)
 Lift/Pump Station Private Sewer Line
 Peak Flow Basin Basement
 Manhole(s) Other (specify below)

Identify **All** Incident Locations by Name, Street Address or Manhole Number as appropriate.
Extra detention pond at Leavenworth Detention Center 100 hwy terr Leavenworth, Ks. 66048

8. Cause of Incident:
 Intentional Bypass for Repair/Construction Equipment Failure
 Excessive Rainfall, Snow Melt Control System Failure
 Unplanned Construction Related Break Power Related Failure
 City Line Break (Not Construction Related) Operations Related Failure
 City Line Blockage Maintenance Related Failure
 Private Line Break Vandalism
 Private Line Blockage Other
 Lagoon High Level

Additional explanation of reason for Incident: (use additional page if necessary)
Power loss to sewer grinder from Westar

9. Corrective Action, if any: (use additional page if necessary)
Westar energy replaced two fuses on utility pole

Name: Chuck Staples Date: 6/19/17
 Title: Superintendent Phone: 913-682-1090
SEE ATTACHED EMAIL KADHE OWNER CONTACTED

When Completed, E-mail to: cseeds@kdheks.gov
 Kansas Department of Health & Environment – Attn: Chris Seeds
 Or Mail to: 1000 SW Jackson St., Suite 420, Topeka , KS 66612-1367
 Fax 785.296.0086

Mike McDonald

From: Chuck Staples
Sent: Monday, July 24, 2017 11:07 AM
To: Mike McDonald
Subject: CCA KDHE Report

Mike: The KDHE report that was sent by Daniel Volle from CCA at 100 Highway Terrace was a copy of a blank that I had sent him. Daniel has inadvertently left my name on this report dated 6/19/17.

Chuck Staples
WPC Superintendent
1800 S 2nd St.
Leavenworth, KS 66048
(913) 682-1090, office
(913) 682-7639, fax

Press Release



FOR IMMEDIATE RELEASE

Media Contact
Travis Levers
724-749-1042
tleverson@utilitysp.net



Service Line Protection Available for Homeowners

Leavenworth, Kansas – The City of Leavenworth has partnered with Service Line Warranties of America (SLWA) to offer protection for homeowners for external water lines. The coverage is voluntary and available at affordable monthly or annual prices.

"In today's economy, it's important for the City to help homeowners find affordable protection for their own private aging infrastructure," said Paul Kramer, City Manager. "We live in an environment where water conservation and ground pollution are extremely important. Through this program, homeowners are more likely to report problems without fear of expensive repairs. Protecting our environment and precious resources through a single-call enrollment process is very convenient for busy homeowners."

The SLWA Service Line Warranty Program protects against leaks and breaks due to normal wear and tear, age, ground shifting and tree root intrusion. If a customer's line is in need of repair, a simple call to the SLWA 24-hour hotline will dispatch a local, licensed contractor familiar with local code. The program provides up to \$4,000 per incident for external water line repairs with an additional allowance for public sidewalk cutting. There are no annual or lifetime limits, service fees or deductibles – just protection when you need it most!

"Homeowners believe that the pipes located on their property will last forever or that the City will repair the line if it breaks," said City Manager Kramer. "That's simply not the case. Many factors contribute to the life expectancy of a line such as tree root intrusion, ground shifting, weather and age – all factors which are covered through the Service Line Warranties of America protection program."

This program is offered at no cost to the City and no public funds are used to promote or administer the program.

"We are pleased to offer affordable protection for water lines to the residents of Leavenworth," said Tom Rusin, CEO of SLWA parent HomeServe USA. "Homeowners will have peace of mind with our first-class customer service experience featuring a 24/7 claim repair line and local, licensed contractors – keeping dollars in the local economy."

SLWA has a longstanding track record of superior service. As the 2013 Winner of the Western Pennsylvania Better Business Bureau Torch Award for Marketplace Ethics, the company is committed to customer service, ethical marketing practices and maintaining an A+ accredited rating with the Better Business Bureau. For questions about this service, or to enroll, please contact SLWA at 866-922-9006 or visit www.slwofa.com. Homeowners can also follow SLWA online for company news and homeowner tips at: www.slwablog.com, www.facebook.com/ServiceLineWarrantiesofAmerica, and www.twitter.com/SLWANews.

About Service Line Warranties of America

Service Line Warranties of America (SLWA) is part of HomeServe USA Corp (HomeServe), a leading provider of home repair solutions serving over 2.7 million customers across the US and Canada. Founded in 2003, SLWA is the trusted source of utility line protection programs endorsed by the National League of Cities. Together with HomeServe, SLWA is dedicated to supplying best-in-class repair plans and delivering superior customer service to consumers directly and through over 400 leading municipal, utility and association partners.

###

PARTNER SUMMARY

PARTNER NAME	PRODUCT DESCRIPTION	BEGIN DATE	END DATE	ENROLLMENTS	CLAIMS FILED
Leavenworth, KS	External Sewer Line Warranty	Jan 01, 2017	Jun 30, 2017	127	0
	External Water Line Warranty	Jan 01, 2017	Jun 30, 2017	293	2
	In-Home Plumbing Warranty	Jan 01, 2017	Jun 30, 2017	9	3
	Total For 1/1/2017 To 6/30/2017			429	5
	TOTAL (To Current Day)			564	6

Mike McDonald

From: Kurt Korinko <kkorinko@utilitysp.net>
Sent: Thursday, January 26, 2017 1:43 PM
To: Paul Kramer
Subject: SLWA Press Release for Our Current Mailing Campaign
Attachments: Leavenworth, KS Press Release.docx

Paul,

Good day to you! I hope that this message finds you well.

Our Marketing Team has created the attached Press Release for your use, as you see fit. As a reminder, drop dates are as follows: 1/31/2017 with a reminder letter two weeks thereafter on 2/14/2017.

If you have any questions or needs, please do not hesitate to contact me directly so that I may be of assistance to you.

Best regards,

Kurt Korinko
Account Manager
Service Line Warranties of America
Office: (724) 749-1053
Cellular: (412) 266-0152

MEMORANDUM

Public Works Department

TO: Mike McDonald, Director of Public Works
FROM: Hal Burdette, Chief Building Inspector 
SUBJECT: SSO Meeting with Plumbing Contractors
DATE: May 11, 2017

The City of Leavenworth sent letters 60 plumbing contractors and invited them to a meeting to review and discuss a few topics and current City policies that these contractors are frequently involved with. The meeting was held in the Commission Chamber of City Hall on April 28, 2017, and began at 4 p.m. The topics covered were as follows:

- 1) Sanitary Sewer Overflows and appropriate responses and cleanup
- 2) Erosion and Sediment control and Land Disturbance Permits
- 3) Grease Trap Inspections

Mark Kramer prepared some literature and made it available to the participants. City staff outlined the policies and took questions and comments from the participants.

At the request of some of the attendees, an email was sent to all who were present that provided them with a website and instructions to access mapping information that the City maintains so that the contractors could review the information available in reference to public sanitary sewers.

Six individuals representing five plumbing contractors attended the meeting, as well as five members of City staff.

I have attached a copy of the sign in sheet.



April 7, 2017

Contractor Name
Address
City State Zip

Re: SPRING 2017 Q & A Discussion

Dear entrepreneur,

In an ongoing effort to improve public knowledge of the City's SSO procedures and remain in compliance with EPA requirements, the City of Leavenworth's Inspection department will hold an informative meeting on April 28, 2017 from 4:00p.m. – 5:00 p.m.

Primarily the discussion will revolve around the International Plumbing and Residential codes and how they are affected by the EPA's recent action with the city.

Some issues that have arisen and will be part of the discussion will be:

- Sanitary Sewer Overflow (SSO) procedures
- Erosion control measures
- Grease trap program and reporting

Feel free to contact me with any questions. (913) 684-0378.

Sincerely,

Mark Kramer
Plumbing Inspector



Hal Burdette

From: Hal Burdette
Sent: Monday, May 01, 2017 9:00 AM
To: Joe Denney; 'cramsey@gonpl.com'; 'michael.d.mccann@gmail.com'; Bill Corbet; 'dbred@aol.com'
Cc: Mark Kramer
Subject: FW: GIS LINK

Gentlemen,

Below is the link to the City's mapping that I mentioned at Friday's meeting. It can also be accessed at the City's website, www.lvks.org. You can find it on the website by choosing the Department tab, then Public Works, and the GIS.

<http://colks.maps.arcgis.com/apps/webappviewer/index.html?id=a71f398ba29a40bab9dd78cf2d84402e>

Once you have brought up the map, click on the 3page icon in the upper left of the screen, and that will open up various layers of information available. Click on the Utilities to expand that category, and you will find Sanitary Sewer as an option. Check the Sanitary Sewer and the information will be added to the map.

You should be able to search by property address, or you can just zoom in on areas of the city where you are looking for information.



Also, if you click on an object, like a manhole, a pop up window will usually appear that gives additional information. The first screen is usually property information, but there are other screens in the pop up that will give more specific information regarding the manhole invert and sewer line information.

All dimensions are approximations, including property lines, and should be field verified, but hopefully you find this information helpful.

Feel free to contact me if you have any questions,

Hal Burdette
Chief Building Inspector
City of Leavenworth
100 N. 5th St.
Leavenworth, KS 66048
913-684-0378